

Rectangular Multi-connector with $\varnothing 10, \varnothing 12$ One-touch Fittings

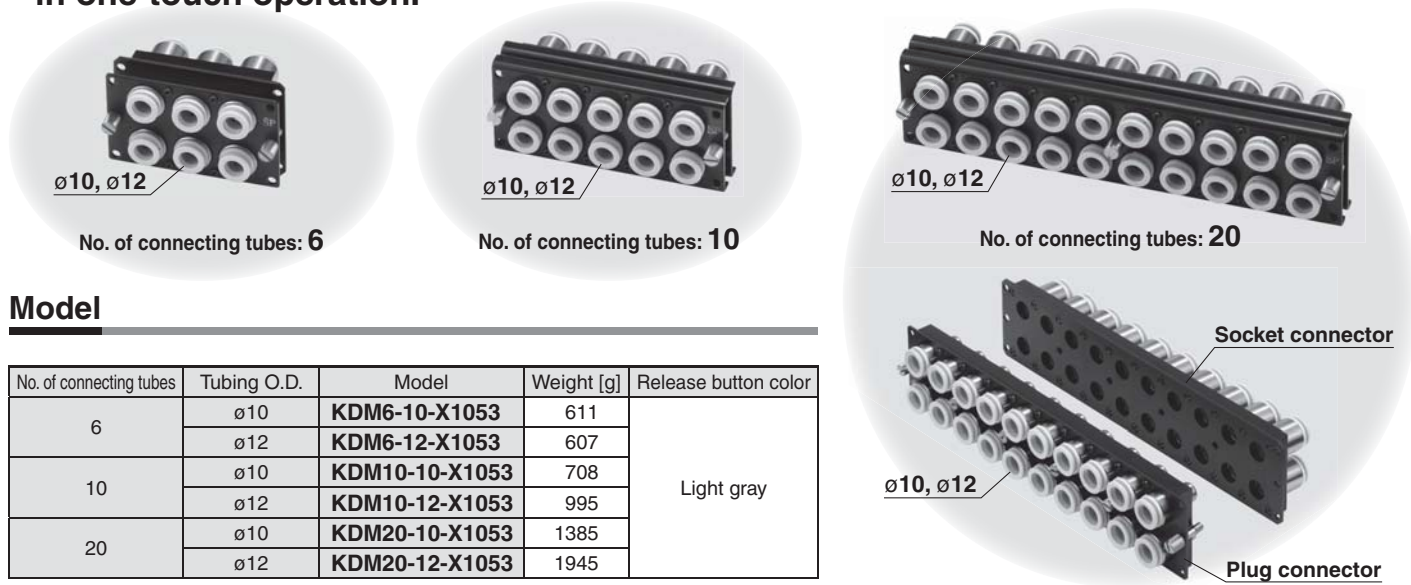

$\varnothing 10, \varnothing 12$ One-touch fittings added to the multi-connector.

■ Multiple pipes (6, 10, 20 tubes) can be collectively connected/disconnected in one-touch operation.



Model

No. of connecting tubes	Tubing O.D.	Model	Weight [g]	Release button color
6	$\varnothing 10$	KDM6-10-X1053	611	Light gray
	$\varnothing 12$	KDM6-12-X1053	607	
10	$\varnothing 10$	KDM10-10-X1053	708	
	$\varnothing 12$	KDM10-12-X1053	995	
20	$\varnothing 10$	KDM20-10-X1053	1385	
	$\varnothing 12$	KDM20-12-X1053	1945	

Applicable Tubing

Tubing material	Nylon, Soft nylon, Polyurethane
Tubing O.D.	$\varnothing 10, \varnothing 12$

Specifications

Fluid	Air
Operating pressure range ^{Note)}	0 to 1 MPa
Proof pressure	1.5 MPa
Ambient and fluid temperature	-5 to 60°C (No freezing)

Note) Please avoid using in a vacuum holding application such as a leak tester, since there is leakage.

Series Variations

	Rectangular Multi-connector/KDM			Multi-connector/DMK	
	No. of connecting tubes			No. of connecting tubes	
	6	10	20	6	12
$\varnothing 2$	●				
$\varnothing 3.2$		●	●	●	●
$\varnothing 4$		●	●	●	●
$\varnothing 6$		●	●		
$\varnothing 8$		●	●		
New $\varnothing 10$	★	★	★		
New $\varnothing 12$	★	★	★		

KDM-X1053



13-EU610-UK

KDM-X1053

Dimensions/Construction

KDM6-□-X1053

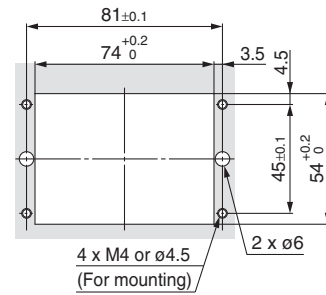
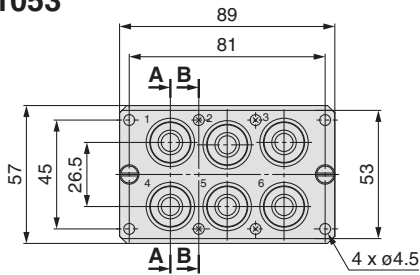

(): Dimensions for KDM6-12-X1053

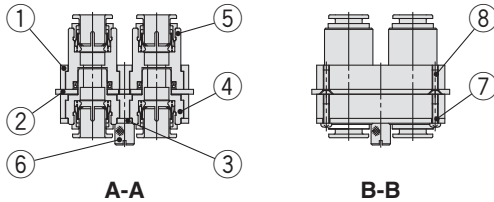
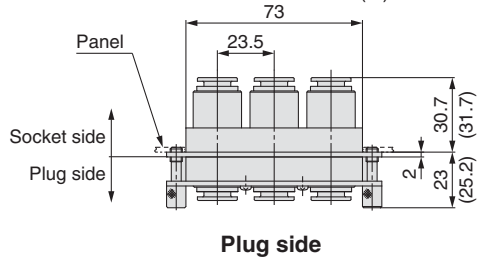

Panel mounting hole

Component Parts

No.	Description	Material	Quantity	Note
1	Case 6 tubes	A6063	2	Black anodized
2	Plate (A) 6 tubes	SPCC	1	Black zinc chromated
3	Plate (B) 6 tubes	SPCC	1	Black zinc chromated
4	Plug	—	6	Electroless nickel plating
5	Socket	—	6	Electroless nickel plating
6	Clamp bolt	C3604	2	Electroless nickel plating
7	Cross recessed round head screw	SWRM	4	M2.5 x 8 Black zinc chromated
8	Cross recessed countersunk head screw	SWRM	4	M2.5 x 8 Black zinc chromated

KDM10-□-X1053

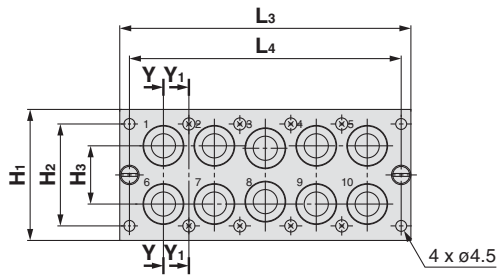

Tubing O.D.: ø10

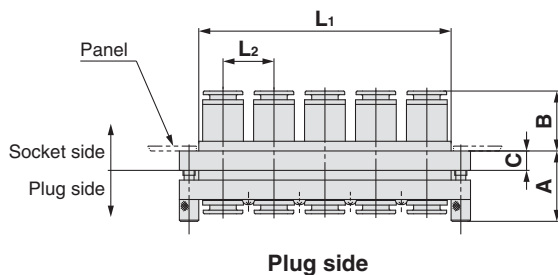
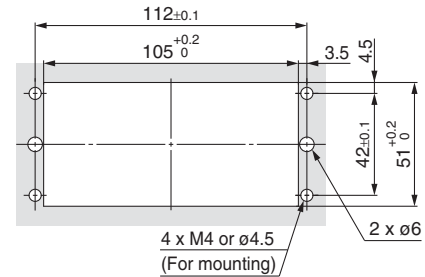

Tubing O.D.: ø12

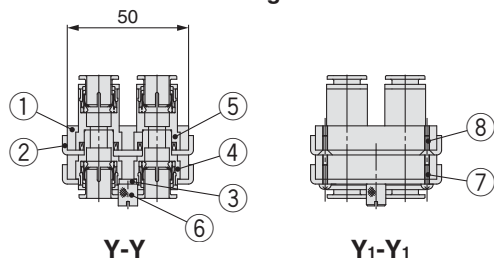
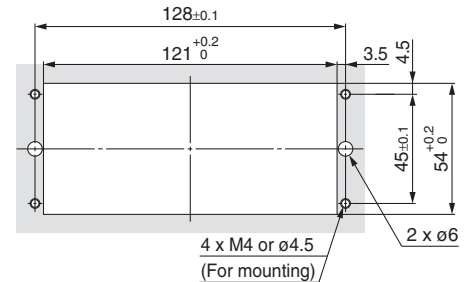

Panel mounting hole

Component Parts

No.	Description	Material	Quantity	Note
1	Case 10 tubes	A6063	2	Black anodized
2	Plate (A) 10 tubes	SPCC	1	Black zinc chromated
3	Plate (B) 10 tubes	SPCC	1	Black zinc chromated
4	Plug	—	10	Electroless nickel plating
5	Socket	—	10	Electroless nickel plating
6	Clamp bolt	C3604	2	Electroless nickel plating
7	Cross recessed round head screw	SWRM	8	M2.5 x 8 Black zinc chromated
8	Cross recessed countersunk head screw	SWRM	8	M2.5 x 8 Black zinc chromated

Model	A	B	C	L1	L2	L3	L4	H1	H2	H3
KDM10-10-X1053	29	24.7	8	104	21	120	112	54	42	24
KDM10-12-X1053	25.2	31.7	2	120	23.5	136	128	57	45	26.5

Dimensions/Construction

KDM20-□-X1053

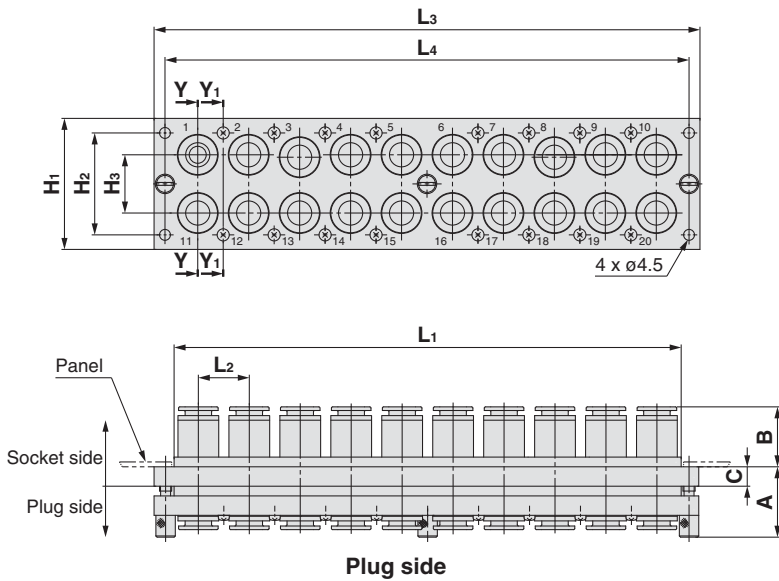

Tubing O.D.: $\phi 10$

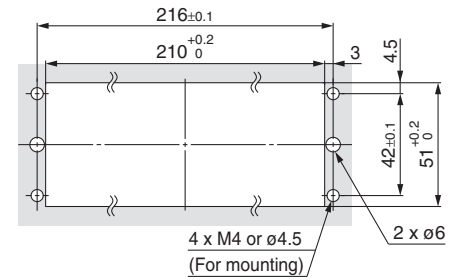

Tubing O.D.: $\phi 12$

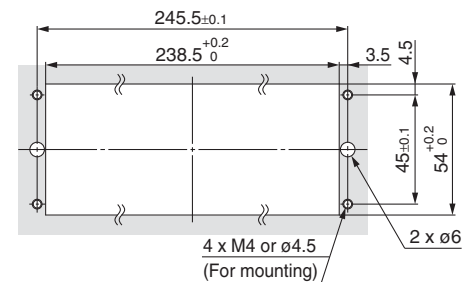

Panel mounting hole

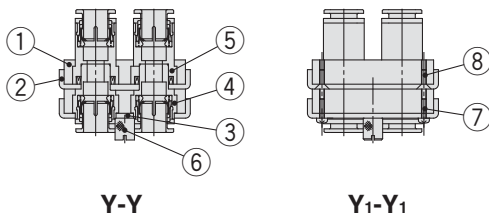

Model	A	B	C	L1	L2	L3	L4	H1	H2	H3
KDM20-10-X1053	29	24.7	8	209	21	225	216	54.5	42	24
KDM20-12-X1053	25.5	31.7	2	237.5	23.5	253.5	245.5	57	45	26.5

Component Parts

No.	Description	Material	Quantity	Note
1	Case 20 tubes	A6063	2	Black anodized
2	Plate (A) 20 tubes	SPCC	1	Black zinc chromated
3	Plate (B) 20 tubes	SPCC	1	Black zinc chromated
4	Plug	—	20	Electroless nickel plating
5	Socket	—	20	Electroless nickel plating
6	Clamp bolt	C3604	3	Electroless nickel plating
7	Cross recessed round head screw	SWRM	16	M2.5 x 8 Black zinc chromated
8	Cross recessed countersunk head screw	SWRM	16	M2.5 x 8 Black zinc chromated

⚠ Caution

1. Socket case fixing bolts (M4) and the hexagon nuts for mounting to the panel should be provided by the customer.

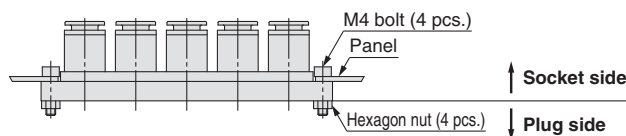

2. A flat blade screwdriver is necessary when tightening the clamp bolt after connecting the plug case to the socket case.

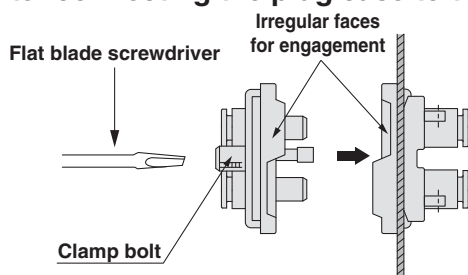



SMC Corporation (Europe)

Austria	☎ +43 (0)2262622800	www.smc.at	office@smc.at
Belgium	☎ +32 (0)33551464	www.smc Pneumatics.be	info@smc Pneumatics.be
Bulgaria	☎ +359 (0)2807670	www.smc.bg	office@smc.bg
Croatia	☎ +385 (0)13707288	www.smc.hr	office@smc.hr
Czech Republic	☎ +420 541424611	www.smc.cz	office@smc.cz
Denmark	☎ +45 70252900	www.smc.dk.com	smc@smc.dk.com
Estonia	☎ +372 6510370	www.smc Pneumatics.ee	smc@smc Pneumatics.ee
Finland	☎ +358 207513513	www.smc.fi	smc.fi@smc.fi
France	☎ +33 (0)164761000	www.smc-france.fr	promotion@smc-france.fr
Germany	☎ +49 (0)61034020	www.smc.de	info@smc.de
Greece	☎ +30 210 2717265	www.smc Hellas.gr	sales@smc Hellas.gr
Hungary	☎ +36 23511390	www.smc.hu	office@smc.hu
Ireland	☎ +353 (0)14039000	www.smc Pneumatics.ie	sales@smc Pneumatics.ie
Italy	☎ +39 0292711	www.smc Italia.it	mailbox@smc Italia.it
Latvia	☎ +371 67817700	www.smc.lv	info@smc.lv

Lithuania	☎ +370 5 2308118	www.smc.lt	info@smc.lt
Netherlands	☎ +31 (0)205318888	www.smc Pneumatics.nl	info@smc Pneumatics.nl
Norway	☎ +47 67129020	www.smc-norge.no	post@smc-norge.no
Poland	☎ +48 (0)222119616	www.smc.pl	office@smc.pl
Portugal	☎ +351 226166570	www.smc.eu	postpt@smc.smces.es
Romania	☎ +40 213205111	www.smcromania.ro	smcromania@smcromania.ro
Russia	☎ +7 8127185445	www.smc-pneumatik.ru	info@smc-pneumatik.ru
Slovakia	☎ +421 (0)413213212	www.smc.sk	office@smc.sk
Slovenia	☎ +386 (0)73885412	www.smc.si	office@smc.si
Spain	☎ +34 902184100	www.smc.eu	post@smc.smces.es
Sweden	☎ +46 (0)86031200	www.smc.nu	post@smc.nu
Switzerland	☎ +41 (0)523963131	www.smc.ch	info@smc.ch
Turkey	☎ +90 212 489 0 440	www.smc Pneumatik.com.tr	info@smc Pneumatik.com.tr
UK	☎ +44 (0)845 121 5122	www.smc Pneumatics.co.uk	sales@smc Pneumatics.co.uk