

# Speed Controller with One-touch Fittings

RoHS

## In-line Type

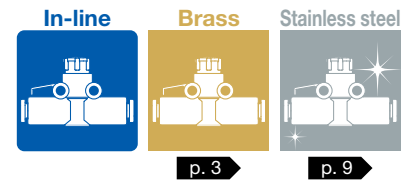

**Reduces flow setting time!**

Easy to use

### Push-lock type

### Knob O.D.: Almost doubled!

#### • Easy to lock

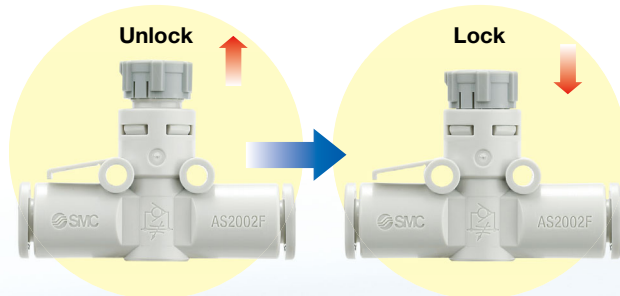

Existing type

Push-lock type

One-push locking

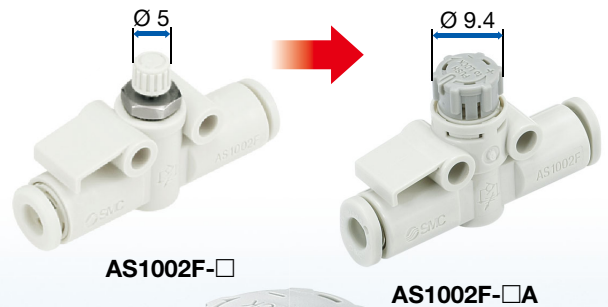

AS1002F-□

AS1002F-□A

Much easier to lock than the existing type which requires a wrench

### Mounting Variations

#### • Direct mounting

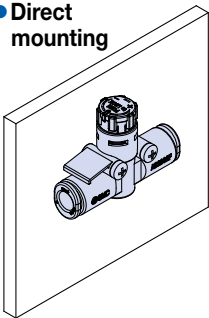

#### • L-bracket mounting [p. 4](#)

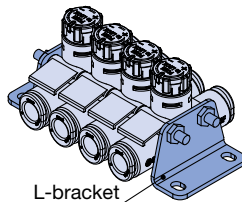

L-bracket

#### • Holder mounting [p. 10](#)

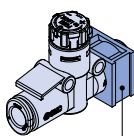

Holder for speed controller

#### • DIN rail mounting [p. 4](#)

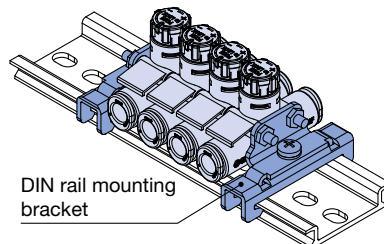

DIN rail mounting bracket

#### New A panel mount type has been added. [p. 5](#)

No tools required, Reduced installation work

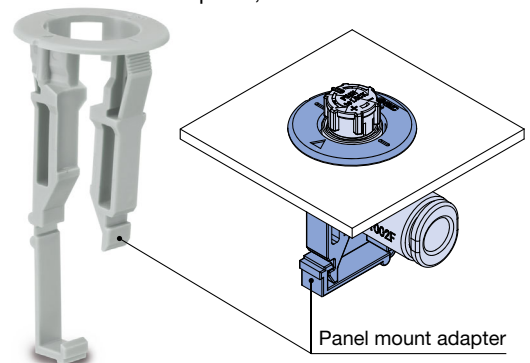

Panel mount adapter

# AS Series



CAT.EUS20-243C-UK

## Flow Rate Reproducibility

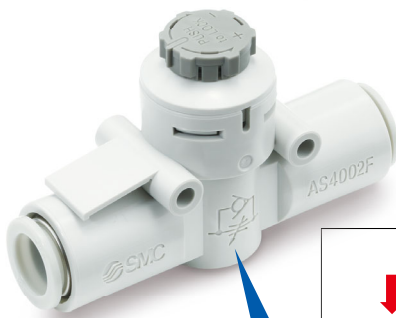

### Improved reproducibility of flow rate

Stable knob position when fully closed (no flow rate) onto the contact face stopper (rotating stopper).  
Minimal flow rate variations between knob rotations

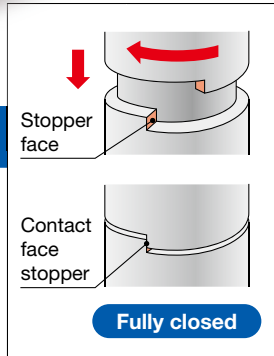

## Lightweight

Weight: Approx. **27 % lighter**

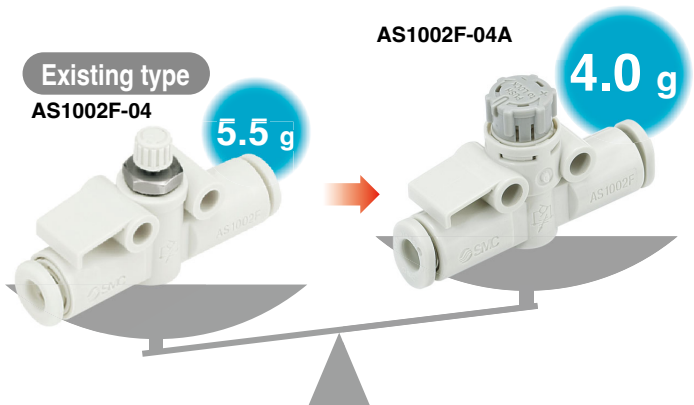

## Larger Knob

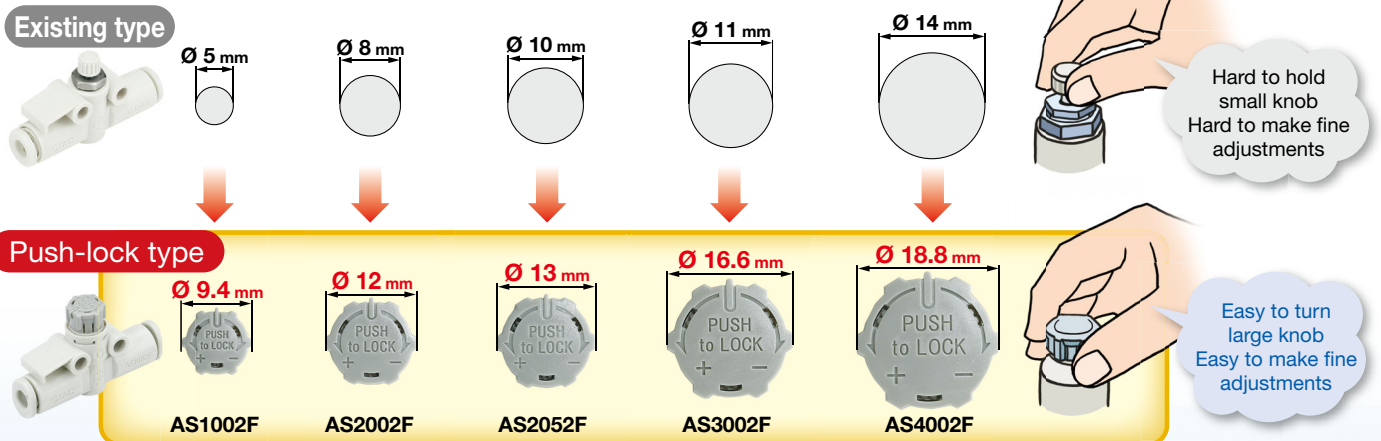

## Easy Identification of Product Type

### By index plate

It is possible to identify the product when multiple controllers are mounted and identify the flow direction by attaching an identification label.



### By colour

Model	Release button colour	
	Metric	Inch
AS□2F	Light grey	Orange
AS□2FG	White	White

## Series Variations

⊙ Electroless nickel plating type p. 3
⊙ Stainless steel type p. 9

	Model	Applicable tubing O.D.												Metal parts material	Applicable tubing material
		Metric size						Inch size							
		3.2	4	6	8	10	12	1/8"	5/32"	1/4"	5/16"	3/8"	1/2"		
	AS1002F	●	●	●				●	●	●				· Brass  · Stainless steel	Nylon (T, TIA series)  Soft nylon (TS, TISA series)  Polyurethane (T, TIUB series)  Fluoropolymer (TLM, TILM series) (TH, TIH series)
	AS2002F		●	●					●	●					
	AS2052F			●	●					●	●				
	AS3002F			●	●	●	●			●	●	●			
	AS4002F					●	●					●	●		



### Made to Order pp. 3, 9

#### Restrictor

- Flow control of air blow and air purge

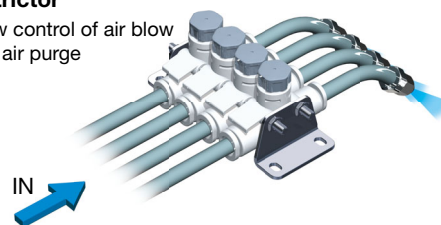

Grease-free (Seal: Fluorine-coated) + Restrictor (Without check valve)	-X21
Restrictor (Without check valve)	-X214

## CONTENTS

### Speed Controller with One-touch Fittings In-line Type AS Series

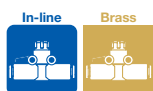

Model, Specifications, Flow Rate and Sonic Conductance, How to Order, Made to Order	p. 3
Options	p. 4
Needle Valve: Flow Rate Characteristics	p. 5
Dimensions	p. 6

### Speed Controller with One-touch Fittings Stainless Steel Series In-line Type AS-FG Series



Model, Specifications, Flow Rate and Sonic Conductance, How to Order, Made to Order	p. 9
Options	p. 10
Needle Valve: Flow Rate Characteristics	p. 11
Dimensions	p. 12

[Related Equipment] Holder for Speed Controller TMH Series	p. 14
--	-------

## Push-Lock Series Variations

### Speed Controller with One-touch Fitting Elbow Type/Universal Type AS Series



### Speed Controller with Indicator AS-FS Series





# Speed Controller with One-touch Fittings In-line Type **AS Series**



RoHS

In-line

Brass

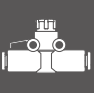
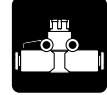

## Model

Model	Applicable tubing O.D.											
	Metric size						Inch size					
	3.2	4	6	8	10	12	1/8"	5/32"	1/4"	5/16"	3/8"	1/2"
AS1002F	●	●	●				●	●	●			
AS2002F		●	●					●	●			
AS2052F			●	●					●	●		
AS3002F			●	●	●	●			●	●	●	
AS4002F					●	●					●	●

## Specifications

Fluid	Air
Proof pressure	1.5 MPa
Max. operating pressure	1 MPa
Min. operating pressure	0.1 MPa
Ambient and fluid temperatures	-5 to 60 °C (No freezing)
Applicable tubing material	Nylon, Soft nylon, Polyurethane*1, FEP, PFA

\*1 Use caution at the max. operating pressure when using soft nylon or polyurethane tubing. (Refer to the **Web catalogue** on [www.smc.eu](http://www.smc.eu) for details.)

## Flow Rate and Sonic Conductance

Model		AS1002F-□A			AS2002F-□A		AS2052F-□A		AS3002F-□A				AS4002F-□A	
Tubing O.D.	Metric size	Ø 3.2	Ø 4	Ø 6	Ø 4	Ø 6	Ø 6	Ø 8	Ø 6	Ø 8	Ø 10	Ø 12	Ø 10	Ø 12
	Inch size	Ø 1/8"	Ø 5/32"	Ø 1/4"	Ø 5/32"	Ø 1/4"	Ø 1/4"	Ø 5/16"	Ø 1/4"	Ø 5/16"	Ø 3/8"	—	Ø 3/8"	Ø 1/2"
C values: Sonic conductance dm³/(s·bar)	Free flow	0.3	0.4	0.6	0.4	0.6	1.0	1.2	1.1	1.6	2.2	2.6	2.4	3.5
	Controlled flow	0.3			0.4	0.6	1.0	1.2	1.3	1.9	2.7	3.3	2.8	4.1
b values: Critical pressure ratio	Free flow	0.3	0.2		0.3	0.1	0.2		0.2				0.3	0.2
	Controlled flow	0.2	0.3	0.4	0.2		0.2	0.3	0.1		0.2		0.1	0.2

\* C and b values are for controlled flow with the needle fully open and free flow with the needle fully closed.

\* The same specifications also apply to the AS-FG series (stainless steel type).

Flow Direction  
Symbol on Body

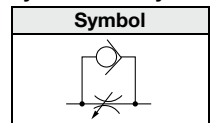

## How to Order

**AS 200 2 F - 06 A -**      

Body size

100	M5 standard
200	1/8 standard
205	1/4 standard
300	3/8 standard
400	1/2 standard

With One-touch fittings

Push-lock type

Applicable tubing O.D.\*1

Metric size	Inch size
23	Ø 3.2*2
04	Ø 4
06	Ø 6
08	Ø 8
10	Ø 10
12	Ø 12
01	Ø 1/8"
03	Ø 5/32"
07	Ø 1/4"
09	Ø 5/16"
11	Ø 3/8"
13	Ø 1/2"

Panel mount adapter

—	None
3	With panel mount adapter

Made to Order

## Made to Order

Made to Order

Lubricant: Vaseline

-X12

Example) AS2002F-04A-X12

Grease-free (Seal: Fluorine-coated) + Restrictor (Without check valve)

-X21

Example) AS2002F-04A-X21

\* Not particle-free

Restrictor (Without check valve)

-X214

Example) AS2002F-04A-X214

Clean Series

10-

Example) 10-AS2002F-04A

\*1 Fluorine grease is used.

\*2 The cleanliness class (ISO class) is 5.

\*3 The panel mount adapter is packaged in a general environment.

## Caution

Be sure to read this before handling the products.  
Refer to the back cover for safety instructions.  
For flow control equipment precautions, refer to the "Handling Precautions for SMC Products" and the "Operation Manual" on the SMC website:  
<https://www.smc.eu>

## Options

### ① L-Bracket

Part no.	Applicable model
<b>AS-10L</b>	AS1002F
<b>AS-20L</b>	AS2002F
<b>AS-25L</b>	AS2052F
<b>AS-30L</b>	AS3002F
<b>AS-40L</b>	AS4002F

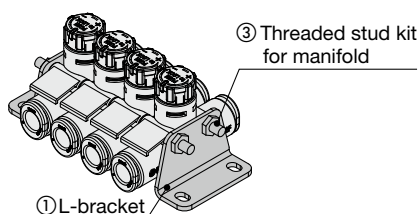

### ② DIN Rail Mounting Bracket

Part no.	Applicable model
<b>AS-10D</b>	AS1002F
<b>AS-20D</b>	AS2002F
<b>AS-25D</b>	AS2052F
<b>AS-30D</b>	AS3002F
<b>AS-40D</b>	AS4002F

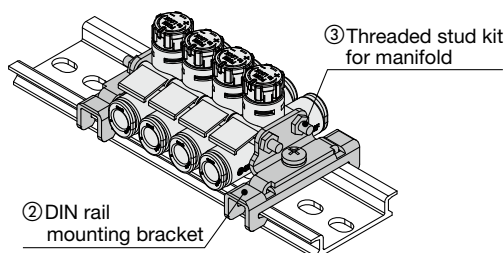

\* The DIN rail needs to be prepared by the customer.

### ③ Threaded Stud Kit for Manifold: Metric Size

Part number				Applicable model
4 stations	6 stations	8 stations	10 stations	
<b>AS-32B</b>	<b>AS-33B</b>	<b>AS-35B</b>	<b>AS-36B</b>	AS1002F-23A
				AS1002F-04A
	<b>AS-34B</b>	<b>AS-36B</b>	<b>AS-37B</b>	AS1002F-06A
			<b>AS-38B</b>	—
<b>AS-32B</b>	<b>AS-34B</b>	<b>AS-36B</b>	<b>AS-37B</b>	AS2002F-04A
			<b>AS-38B</b>	AS2002F-06A
<b>AS-41B</b>	<b>AS-42B</b>	<b>AS-44B</b>	<b>AS-45B</b>	—
				AS2052F-06A
				—
<b>AS-42B</b>	<b>AS-44B</b>	<b>AS-45B</b>	<b>AS-47B</b>	AS2052F-08A
				AS3002F-06A
				—
				AS3002F-08A
				AS3002F-10A
				—
<b>AS-43B</b>	<b>AS-45B</b>	<b>AS-47B</b>	<b>AS-48B</b>	AS3002F-12A
				AS4002F-10A
				—
				AS4002F-12A

### ③ Threaded Stud Kit for Manifold: Inch Size

Part number				Applicable model
4 stations	6 stations	8 stations	10 stations	
<b>AS-32B</b>	<b>AS-33B</b>	<b>AS-35B</b>	<b>AS-36B</b>	AS1002F-01A
				AS1002F-03A
	<b>AS-34B</b>	<b>AS-36B</b>	<b>AS-37B</b>	—
			<b>AS-38B</b>	AS1002F-07A
<b>AS-32B</b>	<b>AS-34B</b>	<b>AS-36B</b>	<b>AS-37B</b>	AS2002F-03A
			<b>AS-38B</b>	—
<b>AS-41B</b>	<b>AS-42B</b>	<b>AS-44B</b>	<b>AS-45B</b>	AS2002F-07A
				—
				AS2052F-09A
<b>AS-42B</b>	<b>AS-44B</b>	<b>AS-45B</b>	<b>AS-47B</b>	—
				AS3002F-07A
				AS3002F-09A
				—
				AS3002F-11A
				—
<b>AS-43B</b>	<b>AS-45B</b>	<b>AS-47B</b>	<b>AS-48B</b>	AS4002F-11A
				—
				AS4002F-13A

### Details of Threaded Stud Kit for Manifold

Threaded stud			Accessories			
Part no.	Length	Quantity	Hexagon nut	Quantity	Flat washer	Quantity
<b>AS-32B</b>	62	2	M3	4	M3	4
<b>AS-33B</b>	72	2				
<b>AS-34B</b>	90	2				
<b>AS-35B</b>	104	2				
<b>AS-36B</b>	114	2				
<b>AS-37B</b>	135	2				
<b>AS-38B</b>	140	2	M4	4	M4	4
<b>AS-41B</b>	78	2				
<b>AS-42B</b>	111	2				
<b>AS-43B</b>	119	2				
<b>AS-44B</b>	147	2				
<b>AS-45B</b>	179	2				
<b>AS-46B</b>	191	2				
<b>AS-47B</b>	236	2				
<b>AS-48B</b>	277	2				

### Ordering Example

Threaded studs for manifold are not included when L-bracket and DIN rail mounting bracket are ordered. Please order them according to the number of stations.

#### Ex.) AS2002F-04A

When connecting 4 pcs. and mounting L-brackets on both sides

- Speed controller  
**AS2002F-04A** ..... 4 pcs.
- L-bracket  
**AS-20L** ..... 2 pcs.
- Threaded stud kit for manifold  
**AS-32B** ..... 1 set

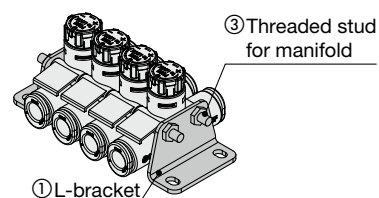

## Options

### ④ Panel Mount Adapter

Panel mount adapter model: Refer to the tables below.  
Metric Size Table

Applicable series	Applicable tubing O.D.					
	23 Ø 3.2	04 Ø 4	06 Ø 6	08 Ø 8	10 Ø 10	12 Ø 12
AS1002F-□A	PMA-1002-A	PMA-1002-B	—	—	—	—
AS2002F-□A	—	PMA-2002	—	—	—	—
AS2052F-□A	—	—	PMA-2052	—	—	—
AS3002F-□A	—	—	PMA-3002	—	—	—
AS4002F-□A	—	—	—	—	PMA-4002	—

\* For the AS1002F, the part number varies depending on the applicable tubing O.D.

### ④ Panel Mount Adapter

Panel mount adapter model: Refer to the tables below.  
Inch Size Table

Applicable series	Applicable tubing O.D.					
	01 Ø 1/8"	03 Ø 5/32"	07 Ø 1/4"	09 Ø 5/16"	11 Ø 3/8"	13 Ø 1/2"
AS1002F-□A	PMA-1002-A	PMA-1002-B	—	—	—	—
AS2002F-□A	—	PMA-2002	—	—	—	—
AS2052F-□A	—	—	PMA-2052	—	—	—
AS3002F-□A	—	—	PMA-3002	—	—	—
AS4002F-□A	—	—	—	—	PMA-4002	—

\* For the AS1002F, the part number varies depending on the applicable tubing O.D.

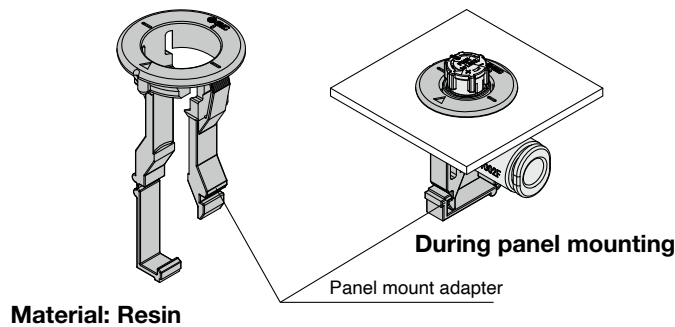

## Needle Valve: Flow Rate Characteristics

\* The flow rate characteristics are representative values.

### AS1002F-□A-□

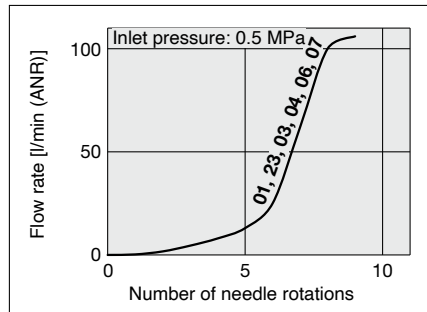

### AS2002F-□A-□

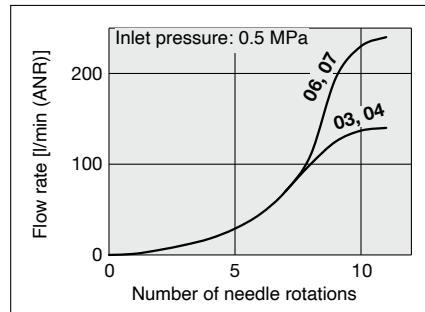

### AS2052F-□A-□

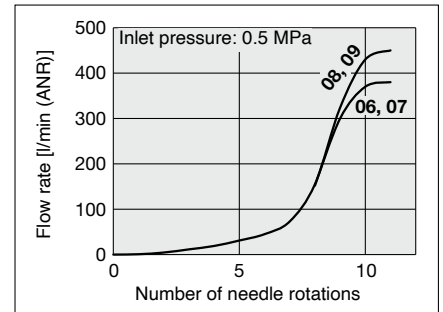

### AS3002F-□A-□

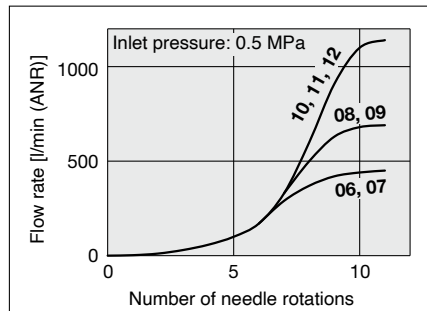

### AS4002F-□A-□

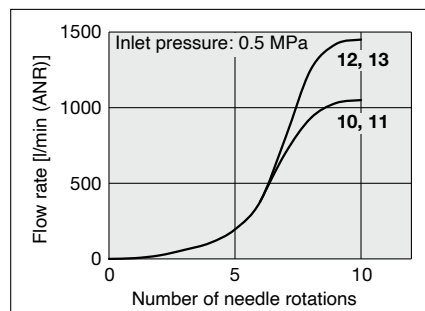

\* The numbers above the flow rate characteristic curves in the charts show the applicable tubing outside diameter as defined by the product number.

Refer to the operation manual for the construction.

## Dimensions

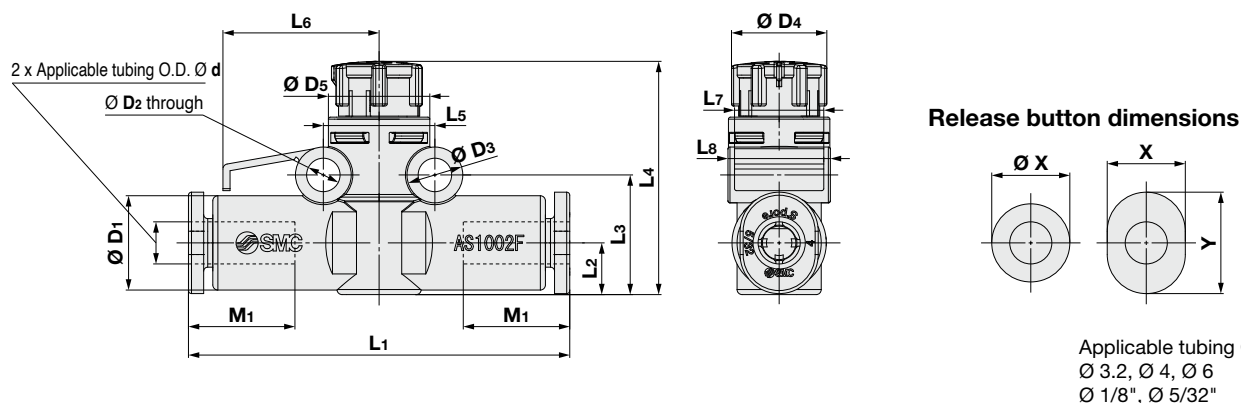

### Metric Size

Model	Applicable tubing O.D. Ø d	Ø D1	Release button		Ø D2	Ø D3	Ø D4	Ø D5	L1	L2	L3	L4*1		L5	L6	L7	L8	M1	Weight [g]
			Ø X(X)	Y								Max.	Min.						
AS1002F-23A	3.2	8.4	6.7	9.5					36.6			24.1	23					13.5	3.7
AS1002F-04A	4	9.3	7.7	10	3.3	5.5	9.4	10	37.6	5.1	11.8	24.1	23	11	15.4	8.8	10.1	13	4
AS1002F-06A	6	11.6	9.7	12					40.1	6.1	12.8	25.1	24				12.3	13	5
AS2002F-04A	4	9.3	7.7	10	3.3	5.5	12	12	41.3	6.3	13.4	31.4	30	12.6	17	10.5	12.3	13	6.1
AS2002F-06A	6	11.6	9.7	12					43.1										6.9
AS2052F-06A	6	12.8	11.5	—	4.3	7.8	13	16	54.2	7.6	17.2	36.2	34.6	17	22.5	12	16.1	17	11.8
AS2052F-08A	8	15.2	13.5	—					57.2	8.5	18.1	37.1	35.5					19	13.8
AS3002F-06A	6	13.2	11.5	—					60									17	18.1
AS3002F-08A	8	15.2	13.5	—	4.5	8	16.6	20	65	9.8	21.7	42.9	41.3	21.8	25	12	20.5	19	20
AS3002F-10A	10	18.5	16.5	—					70.4									21	24.8
AS3002F-12A	12	20.9	18.5	—					76	10.9	22.8	44	42.4				22.1	22	29.1
AS4002F-10A	10	18.5	16.5	—	4.3	8	18.8	26	76.9									21	36.3
AS4002F-12A	12	21.7	18.5	—					81.3	11.3	23.7	51.3	49.7	28	33	14	26.2	22	42

\*1 Reference dimensions

### Inch Size

Model	Applicable tubing O.D. Ø d	Ø D1	Release button		Ø D2	Ø D3	Ø D4	Ø D5	L1	L2	L3	L4*1		L5	L6	L7	L8	M1	Weight [g]
			Ø X(X)	Y								Max.	Min.						
AS1002F-01A	1/8"	8.4	6.7	9.5					36.6			24.1	23					13.5	3.7
AS1002F-03A	5/32"	9.3	7.7	10	3.3	5.5	9.4	10	37.6	5.1	11.8	24.1	23	11	15.4	8.8	10.1	13	4
AS1002F-07A	1/4"	12	10.9	—					40.1	6.2	12.9	25.2	24.1				12.8	13.5	5.2
AS2002F-03A	5/32"	9.3	7.7	10	3.3	5.5	12	12	41.3	6.3	13.4	31.4	30	12.6	17	10.5	12.3	13	6.1
AS2002F-07A	1/4"	12	10.9	—					43.2	6.5	13.6	31.6	30.2				12.8	13.5	7.1
AS2052F-07A	1/4"	13.2	12	—	4.3	7.8	13	16	53.4	7.6	17.2	36.2	34.6	17	22.5	12	16.1	17	12.1
AS2052F-09A	5/16"	15.2	13.5	—					57.2	8.5	18.1	37.1	35.5					19	13.8
AS3002F-07A	1/4"	13.2	12	—					59									17	17.9
AS3002F-09A	5/16"	15.2	13.5	—	4.5	8	16.6	20	65	9.8	21.7	42.9	41.3	21.8	25	12	20.5	19	20
AS3002F-11A	3/8"	18.5	16	—					69.8									21	25
AS4002F-11A	3/8"	18.5	16	—	4.3	8	18.8	26	76.9									21	36.7
AS4002F-13A	1/2"	21.7	20	—					81.3	11.3	23.7	51.3	49.7	28	33	14	26.2	22	40.4

\*1 Reference dimensions

## Dimensions: With Panel Mount Adapter

Refer to the operation manual for panel mounting instructions.

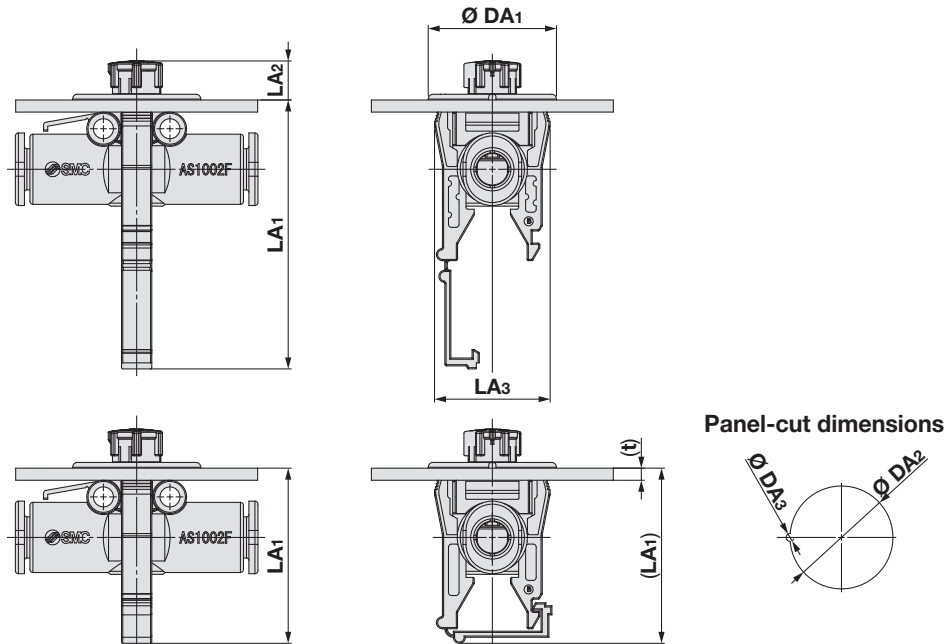

### Metric Size

Model	Applicable tubing O.D. Ø d	LA1*1		LA2*1		LA3*2	Ø DA1	Panel-cut dimensions		Applicable panel thickness t	Weight [g]
		Max.	Min.	Max.	Min.			Ø DA2*3 (+0.1/0)	Ø DA3*3 (+0.1/0)		
AS1002F(G)-23A-3	3.2	44.5	29.0	7.6	6.5	19.1	Ø 21.2	Ø 17.5	Ø 2	1 to 2	5.1
AS1002F(G)-04A-3	4	44.5	29.0	7.6	6.5	19.1	Ø 21.2	Ø 17.5	Ø 2		5.4
AS1002F(G)-06A-3	6	44.5	29.0	7.6	6.5	19.1	Ø 21.2	Ø 17.5	Ø 2		6.3
AS2002F(G)-04A-3	4	53.3	35.2	8.7	7.3	22.1	Ø 24.2	Ø 20.5	Ø 2	1 to 3.5	7.9
AS2002F(G)-06A-3	6	53.3	35.2	8.7	7.3	22.1	Ø 24.2	Ø 20.5	Ø 2		8.7
AS2052F(G)-06A-3	6	59.2	39.6	10.1	8.5	24.1	Ø 26.7	Ø 22.5	Ø 2.5		14.5
AS2052F(G)-08A-3	8	59.2	39.6	10.1	8.5	24.1	Ø 26.7	Ø 22.5	Ø 2.5		16.5
AS3002F(G)-06A-3	6	67.0	44.2	11.3	9.7	28.1	Ø 31.2	Ø 26	Ø 3		22.2
AS3002F(G)-08A-3	8	67.0	44.2	11.3	9.7	28.1	Ø 31.2	Ø 26	Ø 3		24.1
AS3002F(G)-10A-3	10	67.0	44.2	11.3	9.7	28.1	Ø 31.2	Ø 26	Ø 3		28.9
AS3002F(G)-12A-3	12	67.0	44.2	11.3	9.7	28.1	Ø 31.2	Ø 26	Ø 3		33.2
AS4002F(G)-10A-3	10	74.1	48.5	13.0	11.4	34.1	Ø 39.2	Ø 32.5	Ø 5		42.5
AS4002F(G)-12A-3	12	74.1	48.5	13.0	11.4	34.1	Ø 39.2	Ø 32.5	Ø 5		48.2

\*1 Reference dimensions

\*2 Max. dimension before panel mounting

\*3 Be sure to check the following dimensional tolerances or the "Specific Product Precautions" page before cutting the panel. Ø DA2 [+0.1/0] Ø DA3 [+0.1/0]  
In addition, the centre position of Ø DA3 is on the circumference of Ø DA2.

\* Refer to the speed controller dimensions on page 6 for the dimensions of speed controllers not listed in this table.

### Inch Size

Model	Applicable tubing O.D. Ø d	LA1*1		LA2*1		LA3*2	Ø DA1	Panel-cut dimensions		Applicable panel thickness t	Weight [g]
		Max.	Min.	Max.	Min.			Ø DA2*3 (+0.1/0)	Ø DA3*3 (+0.1/0)		
AS1002F(G)-01A-3	1/8"	44.5	29.0	7.6	6.5	19.1	Ø 21.2	Ø 17.5	Ø 2	1 to 2	5.1
AS1002F(G)-03A-3	5/32"	44.5	29.0	7.6	6.5	19.1	Ø 21.2	Ø 17.5	Ø 2		5.4
AS1002F(G)-07A-3	1/4"	44.5	29.0	7.6	6.5	19.1	Ø 21.2	Ø 17.5	Ø 2		6.5
AS2002F(G)-03A-3	5/32"	53.3	35.2	8.7	7.3	22.1	Ø 24.2	Ø 20.5	Ø 2	1 to 3.5	7.9
AS2002F(G)-07A-3	1/4"	53.3	35.2	8.7	7.3	22.1	Ø 24.2	Ø 20.5	Ø 2		8.9
AS2052F(G)-07A-3	1/4"	59.2	39.6	10.1	8.5	24.1	Ø 26.7	Ø 22.5	Ø 2.5		14.8
AS2052F(G)-09A-3	5/16"	59.2	39.6	10.1	8.5	24.1	Ø 26.7	Ø 22.5	Ø 2.5		16.5
AS3002F(G)-07A-3	1/4"	67.0	44.2	11.3	9.7	28.1	Ø 31.2	Ø 26	Ø 3		22.0
AS3002F(G)-09A-3	5/16"	67.0	44.2	11.3	9.7	28.1	Ø 31.2	Ø 26	Ø 3		24.1
AS3002F(G)-11A-3	3/8"	67.0	44.2	11.3	9.7	28.1	Ø 31.2	Ø 26	Ø 3		29.1
AS4002F(G)-11A-3	3/8"	74.1	48.5	13.0	11.4	34.1	Ø 39.2	Ø 32.5	Ø 5		42.9
AS4002F(G)-13A-3	1/2"	74.1	48.5	13.0	11.4	34.1	Ø 39.2	Ø 32.5	Ø 5		46.6

\*1 Reference dimensions

\*2 Max. dimension before panel mounting

\*3 Be sure to check the following dimensional tolerances or the "Specific Product Precautions" page before cutting the panel. Ø DA2 [+0.1/0] Ø DA3 [+0.1/0]  
In addition, the centre position of Ø DA3 is on the circumference of Ø DA2.

\* Refer to the speed controller dimensions on page 6 for the dimensions of speed controllers not listed in this table.



## Dimensions

### L-Bracket

Bracket on a single side

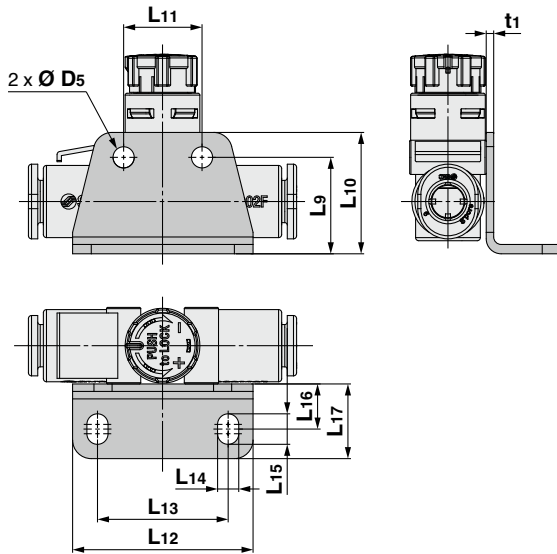

Part no.	Applicable model	D5	L9	L10	L11	L12	L13	L14	L15	L16	L17	t1
AS-10L	AS1002F	3.4	14.8	18.3	11	27.5	19.5	3.4	4.9	7.3	12	1
AS-20L	AS2002F		15.6	19.6	12.6	29	21					1.2
AS-25L	AS2052F		19.6	24.6	17	38	28					1.4
AS-30L	AS3002F	4.5	24.8	29.8	22	43	33	4.5	6.5	9.5	15.5	1.4
AS-40L	AS4002F		25.7	30.7	28	49	39					

### Brackets on both sides

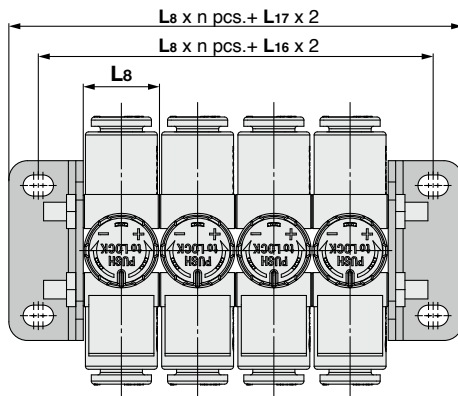

- \* Refer to page 6 for L8.
- \* The figure above shows the manifold with speed controllers connected using two L-brackets and a threaded stud kit for manifold. Refer to page 4 for threaded stud kits for manifold.

### DIN Rail Mounting Bracket

Bracket on a single side

AS1002F

AS2002F

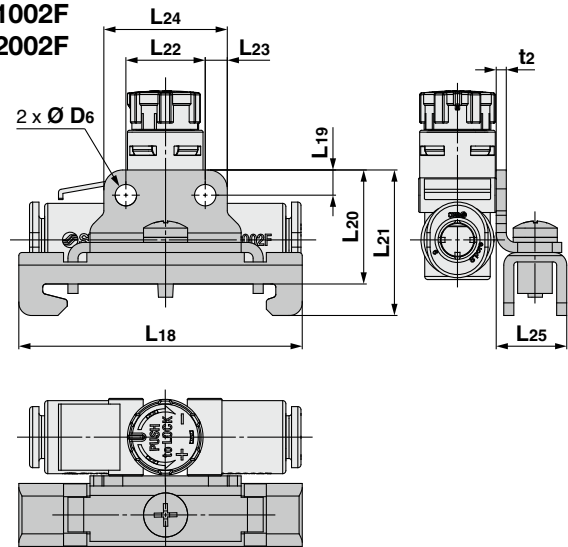

AS2052F

AS3002F

AS4002F

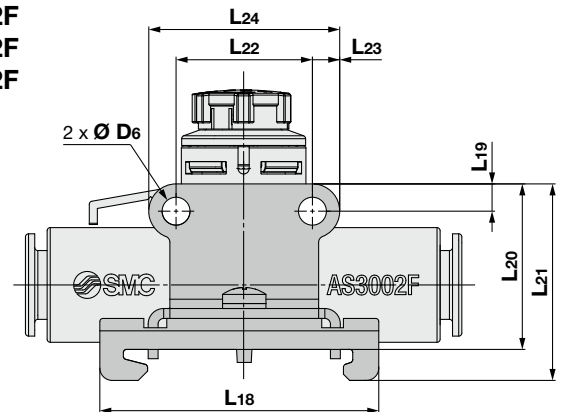

Part no.	Applicable model	D6	L18	L19	L20	L21	L22	L23	L24	L25	t2
AS-10D	AS1002F	3.4	45	3.5	18.2	23.2	11	3.5	18	11.3	1.6
AS-20D	AS2002F			3.5	18.6	23.6	12.6		19.6		
AS-25D	AS2052F			4.4	22	27	17		25.8		
AS-30D	AS3002F	4.5	45	4.4	27.2	32.2	22	4.4	30.8	11.3	1.6
AS-40D	AS4002F			4.4	28.1	33.1	28		36.8		

### Brackets on both sides

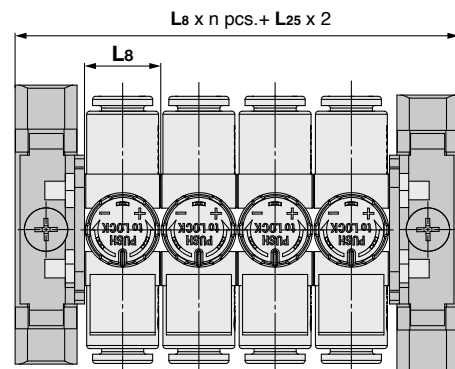

- \* Refer to page 6 for L8.
- \* The figure above shows the manifold with speed controllers connected using two DIN rail mounting brackets and a threaded stud kit for manifold. Refer to page 4 for threaded stud kits for manifold.

# Speed Controller with One-touch Fittings Stainless Steel Series In-line Type **AS-FG Series**

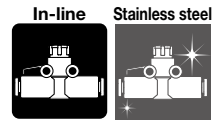
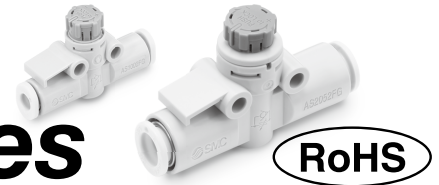

## Model

Model	Applicable tubing O.D.											
	Metric size						Inch size					
	3.2	4	6	8	10	12	1/8"	5/32"	1/4"	5/16"	3/8"	1/2"
AS1002FG	●	●	●				●	●	●			
AS2002FG		●	●					●	●			
AS2052FG			●	●					●	●		
AS3002FG			●	●	●	●			●	●	●	
AS4002FG					●	●					●	●

## Specifications

Fluid	Air
Proof pressure	1.5 MPa
Max. operating pressure	1 MPa
Min. operating pressure	0.1 MPa
Ambient and fluid temperatures	-5 to 60 °C (No freezing)
Applicable tubing material	Nylon, Soft nylon, Polyurethane*1, FEP, PFA

\*1 Use caution at the max. operating pressure when using soft nylon or polyurethane tubing. (Refer to the Web catalogue on [www.smc.eu](http://www.smc.eu) for details.)

## Flow Rate and Sonic Conductance

Model		AS1002FG-□A			AS2002FG-□A		AS2052FG-□A		AS3002FG-□A				AS4002FG-□A	
Tubing O.D.	Metric size	Ø 3.2	Ø 4	Ø 6	Ø 4	Ø 6	Ø 6	Ø 8	Ø 6	Ø 8	Ø 10	Ø 12	Ø 10	Ø 12
	Inch size	Ø 1/8"	Ø 5/32"	Ø 1/4"	Ø 5/32"	Ø 1/4"	Ø 1/4"	Ø 5/16"	Ø 1/4"	Ø 5/16"	Ø 3/8"	—	Ø 3/8"	Ø 1/2"
C values: Sonic conductance dm³/(s·bar)	Free flow	0.3	0.4	0.6	0.4	0.6	1.0	1.2	1.1	1.6	2.2	2.6	2.4	3.5
	Controlled flow	0.3			0.4	0.6	1.0	1.2	1.3	1.9	2.7	3.3	2.8	4.1
b values: Critical pressure ratio	Free flow	0.3	0.2		0.3	0.1	0.2		0.2				0.3	0.2
	Controlled flow	0.2	0.3	0.4	0.2		0.2	0.3	0.1		0.2		0.1	0.2

\* C and b values are for controlled flow with the needle fully open and free flow with the needle fully closed.

### Flow Direction Symbol on Body

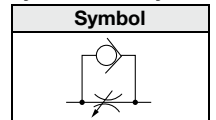

## How to Order

**AS 200 2 F G - 06 A -**

Body size

100	M5 standard
200	1/8 standard
205	1/4 standard
300	3/8 standard
400	1/2 standard

Made to Order

With One-touch fittings

Push-lock type

Stainless steel type  
(Stainless steel 303)

\* The material can be visually identified by colour of the release button.

Stainless steel type: White

\* White is also used for inch size.

Applicable tubing O.D.\*1

Metric size	Inch size
23	Ø 3.2*2
04	Ø 4
06	Ø 6
08	Ø 8
10	Ø 10
12	Ø 12
01	Ø 1/8"
03	Ø 5/32"
07	Ø 1/4"
09	Ø 5/16"
11	Ø 3/8"
13	Ø 1/2"

\*1 For selecting applicable tubing O.D., refer to the "Model" shown above.

\*2 Use Ø 1/8" tubing.

## Made to Order



Lubricant: Vaseline

-X12

Example) AS2002FG-06A-X12

Grease-free (Seal: Fluorine-coated) + Restrictor (Without check valve)

-X21

Example) AS2002FG-06A-X21

\* Not particle-free

Restrictor (Without check valve)

-X214

Example) AS2002FG-06A-X214

Clean Series

10-

Example) 10-AS2002FG-06A

\*1 Fluorine grease is used.

\*2 The cleanliness class (ISO class) is 5.

## Options

### ① L-Bracket

Part no.	Applicable model
<b>AS-10L</b>	AS1002FG
<b>AS-20L</b>	AS2002FG
<b>AS-25L</b>	AS2052FG
<b>AS-30L</b>	AS3002FG
<b>AS-40L</b>	AS4002FG

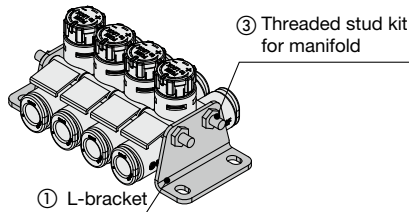

### ② DIN Rail Mounting Bracket

Part no.	Applicable model
<b>AS-10D</b>	AS1002FG
<b>AS-20D</b>	AS2002FG
<b>AS-25D</b>	AS2052FG
<b>AS-30D</b>	AS3002FG
<b>AS-40D</b>	AS4002FG

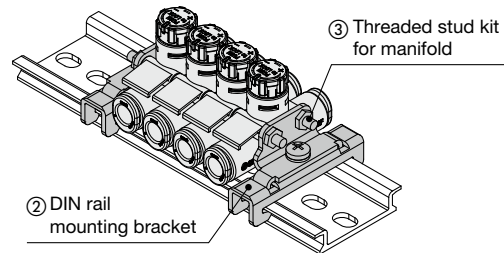

\* The DIN rail needs to be prepared by the customer.

### ③ Threaded Stud Kit for Manifold: Metric Size

Part number				Applicable model
4 stations	6 stations	8 stations	10 stations	
<b>AS-32B</b>	<b>AS-33B</b>	<b>AS-35B</b>	<b>AS-36B</b>	AS1002FG-23A
				AS1002FG-04A
	<b>AS-34B</b>	<b>AS-36B</b>	<b>AS-37B</b>	AS1002FG-06A
			<b>AS-38B</b>	—
<b>AS-32B</b>	<b>AS-34B</b>	<b>AS-36B</b>	<b>AS-37B</b>	AS2002FG-04A
			<b>AS-38B</b>	AS2002FG-06A
<b>AS-41B</b>	<b>AS-42B</b>	<b>AS-44B</b>	<b>AS-45B</b>	AS2052FG-06A
				—
				AS2052FG-08A
<b>AS-42B</b>	<b>AS-44B</b>	<b>AS-45B</b>	<b>AS-47B</b>	AS3002FG-06A
				—
				AS3002FG-08A
				AS3002FG-10A
				—
				AS3002FG-12A
<b>AS-43B</b>	<b>AS-45B</b>	<b>AS-47B</b>	<b>AS-48B</b>	AS4002FG-10A
				—
				AS4002FG-12A

### ③ Threaded Stud Kit for Manifold: Inch Size

Part number				Applicable model
4 stations	6 stations	8 stations	10 stations	
<b>AS-32B</b>	<b>AS-33B</b>	<b>AS-35B</b>	<b>AS-36B</b>	AS1002FG-01A
				AS1002FG-03A
	<b>AS-34B</b>	<b>AS-36B</b>	<b>AS-37B</b>	—
			<b>AS-38B</b>	AS1002FG-07A
<b>AS-32B</b>	<b>AS-34B</b>	<b>AS-36B</b>	<b>AS-37B</b>	AS2002FG-03A
			<b>AS-38B</b>	—
<b>AS-41B</b>	<b>AS-42B</b>	<b>AS-44B</b>	<b>AS-45B</b>	AS2002FG-07A
				—
				AS2052FG-09A
<b>AS-42B</b>	<b>AS-44B</b>	<b>AS-45B</b>	<b>AS-47B</b>	—
				AS3002FG-07A
				AS3002FG-09A
				—
				AS3002FG-11A
				—
<b>AS-43B</b>	<b>AS-45B</b>	<b>AS-47B</b>	<b>AS-48B</b>	AS4002FG-11A
				—
				AS4002FG-13A

### Details of Threaded Stud Kit for Manifold

Threaded stud			Accessories			
Part no.	Length	Quantity	Hexagon nut	Quantity	Flat washer	Quantity
<b>AS-32B</b>	62	2	M3	4	M3	4
<b>AS-33B</b>	72	2				
<b>AS-34B</b>	90	2				
<b>AS-35B</b>	104	2				
<b>AS-36B</b>	114	2				
<b>AS-37B</b>	135	2				
<b>AS-38B</b>	140	2	M4	4	M4	4
<b>AS-41B</b>	78	2				
<b>AS-42B</b>	111	2				
<b>AS-43B</b>	119	2				
<b>AS-44B</b>	147	2				
<b>AS-45B</b>	179	2				
<b>AS-46B</b>	191	2				
<b>AS-47B</b>	236	2				
<b>AS-48B</b>	277	2				

### Ordering Example

Threaded studs for manifold are not included when L-bracket and DIN rail mounting bracket are ordered. Please order them according to the number of stations.

#### Ex.) AS2002FG-04A

When connecting 4 pcs. and mounting L-brackets on both sides

- Speed controller  
**AS2002FG-04A** ..... 4 pcs.
- L-bracket  
**AS-20L** ..... 2 pcs.
- Threaded stud kit for manifold  
**AS-32B** ..... 1 set

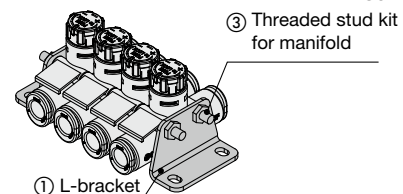

# AS-FG Series

## Options

### ④ Panel Mount Adapter

Panel mount adapter model: Refer to the tables below.  
Metric Size Table

Applicable series	Applicable tubing O.D.					
	23	04	06	08	10	12
	Ø 3.2	Ø 4	Ø 6	Ø 8	Ø 10	Ø 12
AS1002FG-□A	PMA-1002-A	PMA-1002-B	—	—	—	—
AS2002FG-□A	—	PMA-2002	—	—	—	—
AS2052FG-□A	—	—	PMA-2052	—	—	—
AS3002FG-□A	—	—	PMA-3002	—	—	—
AS4002FG-□A	—	—	—	—	PMA-4002	—

\* For the AS1002FG, the part number varies depending on the applicable tubing O.D.

### ④ Panel Mount Adapter

Panel mount adapter model: Refer to the tables below.  
Inch Size Table

Applicable series	Applicable tubing O.D.					
	01	03	07	09	11	13
	Ø 1/8"	Ø 5/32"	Ø 1/4"	Ø 5/16"	Ø 3/8"	Ø 1/2"
AS1002FG-□A	PMA-1002-A	PMA-1002-B	—	—	—	—
AS2002FG-□A	—	PMA-2002	—	—	—	—
AS2052FG-□A	—	—	PMA-2052	—	—	—
AS3002FG-□A	—	—	PMA-3002	—	—	—
AS4002FG-□A	—	—	—	—	PMA-4002	—

\* For the AS1002FG, the part number varies depending on the applicable tubing O.D.

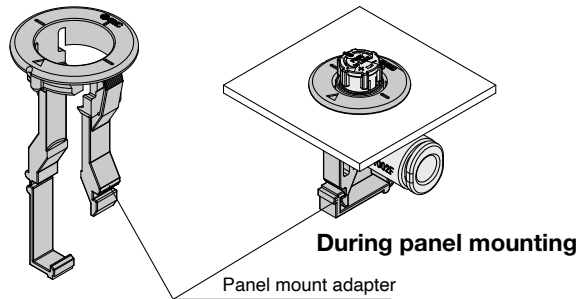

The dimensions when the panel mount adapter is mounted to the speed controller are the same as those of the standard AS□□□2F-□A-3 (brass type).

## Needle Valve: Flow Rate Characteristics

\* The flow rate characteristics are representative values.

### AS1002FG-□A

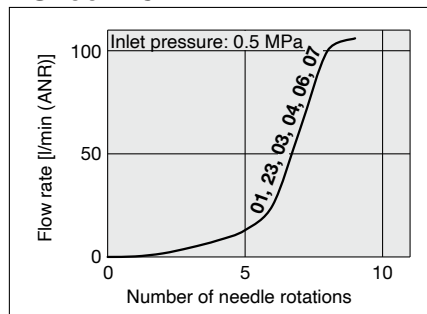

### AS2002FG-□A

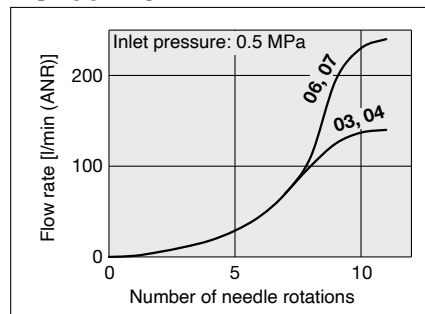

### AS2052FG-□A

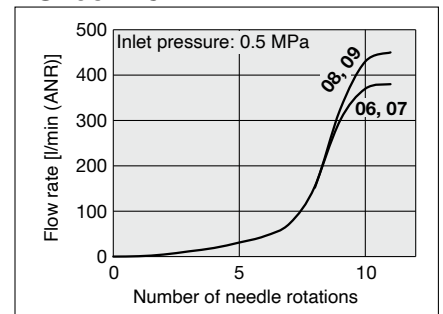

### AS3002FG-□A

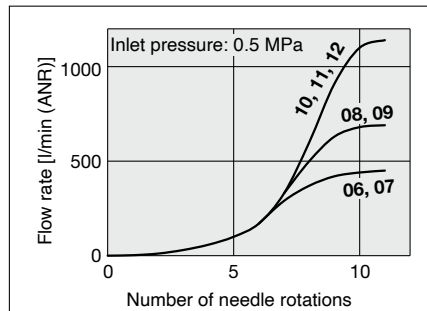

### AS4002FG-□A

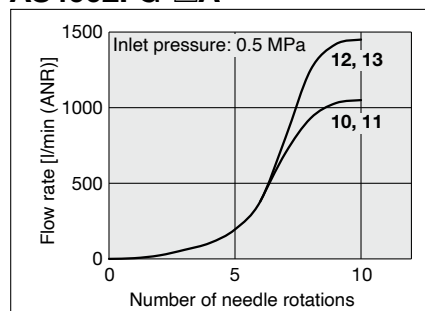

\* The numbers above the flow rate characteristic curves in the charts show the applicable tubing outside diameter as defined by the product number.

Refer to the operation manual for the construction.



## Dimensions

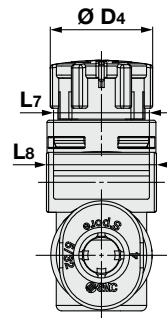
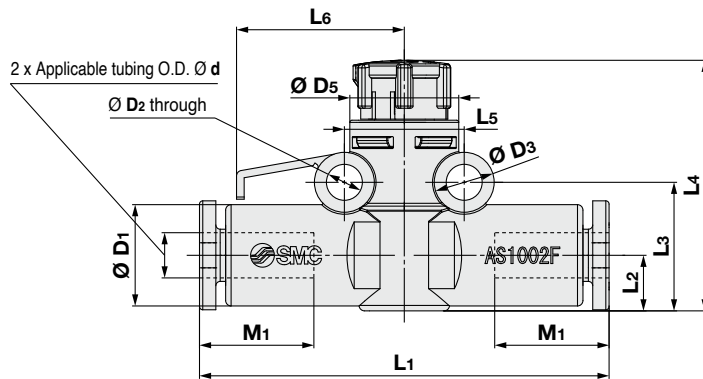

Release button dimensions

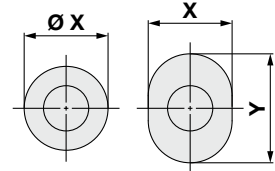

Applicable tubing O.D.:  
Ø 3.2, Ø 4, Ø 6  
Ø 1/8", Ø 5/32"

### Metric Size

Model	Applicable tubing O.D. Ø d	Ø D1	Release button Ø X(X) Y		Ø D2	Ø D3	Ø D4	Ø D5	L1	L2	L3	L4*1		L5	L6	L7	L8	M1	Weight [g]
												Max.	Min.						
AS1002FG-23A	3.2	8.4	6.7	9.5					36.6			24.1	23					13.5	3.7
AS1002FG-04A	4	9.3	7.7	10	3.3	5.5	9.4	10	37.6	5.1	11.8	24.1	23	11	15.4	8.8	10.1	13	4
AS1002FG-06A	6	11.6	9.7	12					40.1	6.1	12.8	25.1	24				12.3		5
AS2002FG-04A	4	9.3	7.7	10	3.3	5.5	12	12	41.3	6.3	13.4	31.4	30	12.6	17	10.5	12.3	13	6.1
AS2002FG-06A	6	11.6	9.7	12					43.1										6.9
AS2052FG-06A	6	12.8	11.5	—	4.3	7.8	13	16	54.2	7.6	17.2	36.2	34.6	17	22.5	12	16.1	17	11.8
AS2052FG-08A	8	15.2	13.5	—					57.2	8.5	18.1	37.1	35.5					19	13.8
AS3002FG-06A	6	13.2	11.5	—					60									17	18.1
AS3002FG-08A	8	15.2	13.5	—	4.5	8	16.6	20	65	9.8	21.7	42.9	41.3	21.8	25	12	20.5	19	20
AS3002FG-10A	10	18.5	16.5	—					70.4									21	24.8
AS3002FG-12A	12	20.9	18.5	—					76	10.9	22.8	44	42.4				22.1	22	29.1
AS4002FG-10A	10	18.5	16.5	—	4.3	8	18.8	26	76.9									21	36.3
AS4002FG-12A	12	21.7	18.5	—					81.3	11.3	23.7	51.3	49.7	28	33	14	26.2	22	42

\*1 Reference dimensions

### Inch Size

Model	Applicable tubing O.D. Ø d	Ø D1	Release button Ø X(X) Y		Ø D2	Ø D3	Ø D4	Ø D5	L1	L2	L3	L4*1		L5	L6	L7	L8	M1	Weight [g]
												Max.	Min.						
AS1002FG-01A	1/8"	8.4	6.7	9.5					36.6			24.1	23					13.5	3.7
AS1002FG-03A	5/32"	9.3	7.7	10	3.3	5.5	9.4	10	37.6	5.1	11.8	24.1	23	11	15.4	8.8	10.1	13	4
AS1002FG-07A	1/4"	12	10.9	—					40.1	6.2	12.9	25.2	24.1				12.8	13.5	5.2
AS2002FG-03A	5/32"	9.3	7.7	10	3.3	5.5	12	12	41.3	6.3	13.4	31.4	30	12.6	17	10.5	12.3	13	6.1
AS2002FG-07A	1/4"	12	10.9	—					43.2	6.5	13.6	31.6	30.2				12.8	13.5	7.1
AS2052FG-07A	1/4"	13.2	12	—	4.3	7.8	13	16	53.4	7.6	17.2	36.2	34.6	17	22.5	12	16.1	17	12.1
AS2052FG-09A	5/16"	15.2	13.5	—					57.2	8.5	18.1	37.1	35.5					19	13.8
AS3002FG-07A	1/4"	13.2	12	—					59									17	17.9
AS3002FG-09A	5/16"	15.2	13.5	—	4.5	8	16.6	20	65	9.8	21.7	42.9	41.3	21.8	25	12	20.5	19	20
AS3002FG-11A	3/8"	18.5	16	—					69.8									21	25
AS4002FG-11A	3/8"	18.5	16	—	4.3	8	18.8	26	76.9									21	36.7
AS4002FG-13A	1/2"	21.7	20	—					81.3	11.3	23.7	51.3	49.7	28	33	14	26.2	22	40.4

\*1 Reference dimensions

# AS-FG Series

## Dimensions

### L-Bracket

Bracket on a single side

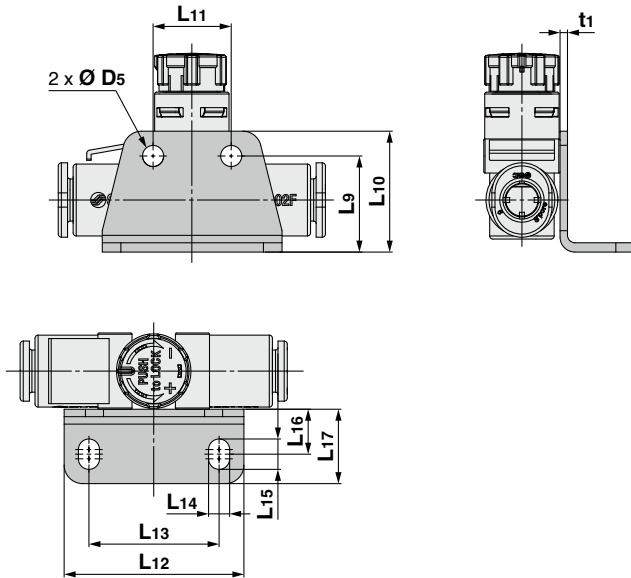

Part no.	Applicable model	D5	L9	L10	L11	L12	L13	L14	L15	L16	L17	t1
AS-10L	AS1002FG	3.4	14.8	18.3	11	27.5	19.5	3.4	4.9	7.3	12	1
AS-20L	AS2002FG		15.6	19.6	12.6	29	21					1.2
AS-25L	AS2052FG		19.6	24.6	17	38	28					1.4
AS-30L	AS3002FG	4.5	24.8	29.8	22	43	33	4.5	6.5	9.5	15.5	1.4
AS-40L	AS4002FG		25.7	30.7	28	49	39					

### Brackets on both sides

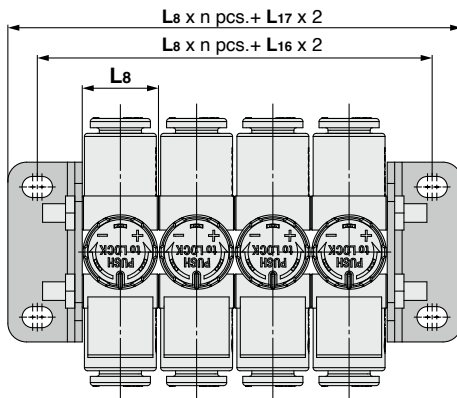

- \* Refer to page 12 for L8.
- \* The figure above shows the manifold with speed controllers connected using two L-brackets and a threaded stud kit for manifold. Refer to page 10 for threaded stud kits for manifold.

### DIN Rail Mounting Bracket

Bracket on a single side

AS1002FG

AS2002FG

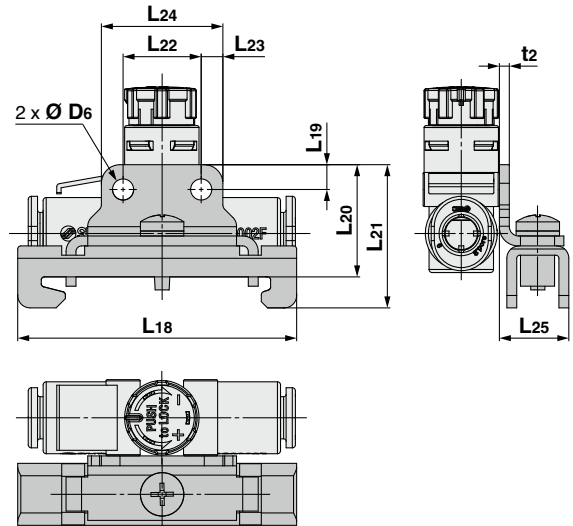

AS2052FG

AS3002FG

AS4002FG

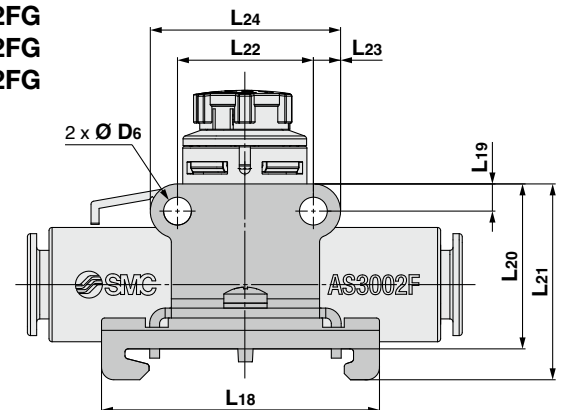

Part no.	Applicable model	D6	L18	L19	L20	L21	L22	L23	L24	L25	t2
AS-10D	AS1002FG	3.4	45	3.5	18.2	23.2	11	3.5	18	11.3	1.6
AS-20D	AS2002FG			3.5	18.6	23.6	12.6		19.6		
AS-25D	AS2052FG			4.4	22	27	17		25.8		
AS-30D	AS3002FG	4.5		4.4	27.2	32.2	22	4.4	30.8		
AS-40D	AS4002FG				28.1	33.1	28		36.8		

### Brackets on both sides

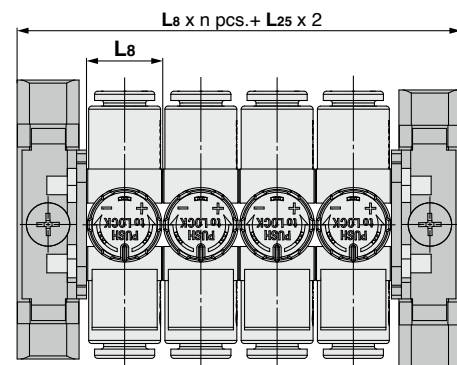

- \* Refer to page 12 for L8.
- \* The figure above shows the manifold with speed controllers connected using two DIN rail mounting brackets and a threaded stud kit for manifold. Refer to page 10 for threaded stud kits for manifold.

## Related Equipment

# Holder for Speed Controller TMH Series

A holder for securing a speed controller with One-touch fittings (In-line type)

Possible to hold a single controller

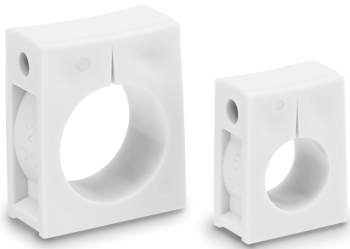

### Holder mounting

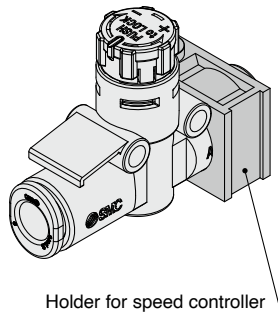

## Specifications

Ambient temperature	-20 to 60 °C
Material	Polypropylene
Colour	White

Accessory: Cross Recessed Round Head Screw for Mounting (Zinc chromated)

Part no.		Size (Nominal x Length)	Quantity
Metric size	Inch size		
TMH-23J	TMH-01J	M3 x 15	1
TMH-04J	TMH-03J		
TMH-06J	TMH-07J	M3 x 20	
TMH-06	TMH-07		
TMH-08	TMH-09	M4 x 25	
TMH-10	—		
TMH-12	TMH-13	M4 x 35	

## Series

Select the applicable holder/TMH for each speed controller from the table below.

### Metric Size

Tubing size	Applicable tubing					
	23	04	06	08	10	12
Applicable model	Ø 3.2	Ø 4	Ø 6	Ø 8	Ø 10	Ø 12
AS1002F(G)	TMH-23J	TMH-04J	TMH-06J			
AS2002F(G)						
AS2052F(G)			TMH-06	TMH-08		
AS3002F(G)			TMH-07			
AS4002F(G)					TMH-10	TMH-12
						TMH-13

\* The applicable TMH for the AS1002F(G)-02 is not available.

### Inch Size

Tubing size	Applicable tubing					
	01	03	07	09	11	13
Applicable model	Ø 1/8"	Ø 5/32"	Ø 1/4"	Ø 5/16"	Ø 3/8"	Ø 1/2"
AS1002F(G)	TMH-01J	TMH-03J	TMH-07J			
AS2002F(G)						
AS2052F(G)			TMH-07	TMH-09		
AS3002F(G)						
AS4002F(G)					TMH-10	TMH-13

## Dimensions

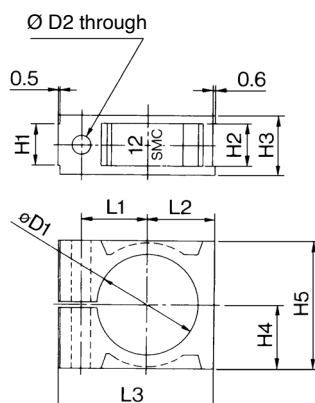

Part no.		Ø D1	Ø D2	H1	H2	H3	H4	H5	L1	L2	L3	Symbol
Metric size	Inch size											
TMH-23J	TMH-01J	8.5	3.3	4.5	4.6	7.5	6	12	7.2	6.6	18	1/8J
TMH-04J	TMH-03J	9.4										4 5/32J
TMH-06J	—	11.7	3.3	6.3	6.4	9.3	7.7	15.4	8.5	8.3	21	6J
—	TMH-07J	12.1										1/4J
TMH-06	—	13.1	4.3									6
—	TMH-07	13.5		7.1	7.2	11.1	10	20	11	10.6	26.5	1/4
TMH-08	TMH-09	15.5	4.3									8 5/16
TMH-10	—	18.8										10
TMH-12	—	21.2		9.5	9.6	13.5	14	28	14.2	14.6	34	12
—	TMH-13	22										1/2

## Safety Instructions

These safety instructions are intended to prevent hazardous situations and/or equipment damage. These instructions indicate the level of potential hazard with the labels of “Caution,” “Warning” or “Danger.” They are all important notes for safety and must be followed in addition to International Standards (ISO/IEC) <sup>1)</sup>, and other safety regulations.

### Danger:

**Danger** indicates a hazard with a high level of risk which, if not avoided, will result in death or serious injury.

### Warning:

**Warning** indicates a hazard with a medium level of risk which, if not avoided, could result in death or serious injury.

### Caution:

**Caution** indicates a hazard with a low level of risk which, if not avoided, could result in minor or moderate injury.

- 1) ISO 4414: Pneumatic fluid power – General rules and safety requirements for systems and their components.  
ISO 4413: Hydraulic fluid power – General rules and safety requirements for systems and their components.  
IEC 60204-1: Safety of machinery – Electrical equipment of machines. (Part 1: General requirements)  
ISO 10218-1: Robots and robotic devices - Safety requirements for industrial robots - Part 1: Robots.  
etc.

## Warning

### 1. The compatibility of the product is the responsibility of the person who designs the equipment or decides its specifications.

Since the product specified here is used under various operating conditions, its compatibility with specific equipment must be decided by the person who designs the equipment or decides its specifications based on necessary analysis and test results. The expected performance and safety assurance of the equipment will be the responsibility of the person who has determined its compatibility with the product. This person should also continuously review all specifications of the product referring to its latest catalogue information, with a view to giving due consideration to any possibility of equipment failure when configuring the equipment.

### 2. Only personnel with appropriate training should operate machinery and equipment.

The product specified here may become unsafe if handled incorrectly. The assembly, operation and maintenance of machines or equipment including our products must be performed by an operator who is appropriately trained and experienced.

### 3. Do not service or attempt to remove product and machinery/equipment until safety is confirmed.

1. The inspection and maintenance of machinery/equipment should only be performed after measures to prevent falling or runaway of the driven objects have been confirmed.
2. When the product is to be removed, confirm that the safety measures as mentioned above are implemented and the power from any appropriate source is cut, and read and understand the specific product precautions of all relevant products carefully.
3. Before machinery/equipment is restarted, take measures to prevent unexpected operation and malfunction.

### 4. Our products cannot be used beyond their specifications. Our products are not developed, designed, and manufactured to be used under the following conditions or environments.

**Use under such conditions or environments is not covered.**

1. Conditions and environments outside of the given specifications, or use outdoors or in a place exposed to direct sunlight.
2. Use for nuclear power, railways, aviation, space equipment, ships, vehicles, military application, equipment affecting human life, body, and property, fuel equipment, entertainment equipment, emergency shut-off circuits, press clutches, brake circuits, safety equipment, etc., and use for applications that do not conform to standard specifications such as catalogues and operation manuals.
3. Use for interlock circuits, except for use with double interlock such as installing a mechanical protection function in case of failure. Please periodically inspect the product to confirm that the product is operating properly.

## Caution

**We develop, design, and manufacture our products to be used for automatic control equipment, and provide them for peaceful use in manufacturing industries.**

**Use in non-manufacturing industries is not covered.**

Products we manufacture and sell cannot be used for the purpose of transactions or certification specified in the Measurement Act.

The new Measurement Act prohibits use of any unit other than SI units in Japan.

## Limited warranty and Disclaimer/Compliance Requirements

The product used is subject to the following “Limited warranty and Disclaimer” and “Compliance Requirements”. Read and accept them before using the product.

### Limited warranty and Disclaimer

1. The warranty period of the product is 1 year in service or 1.5 years after the product is delivered, whichever is first. <sup>2)</sup> Also, the product may have specified durability, running distance or replacement parts. Please consult your nearest sales branch.
2. For any failure or damage reported within the warranty period which is clearly our responsibility, a replacement product or necessary parts will be provided. This limited warranty applies only to our product independently, and not to any other damage incurred due to the failure of the product.
3. Prior to using SMC products, please read and understand the warranty terms and disclaimers noted in the specified catalogue for the particular products.
- 2) Vacuum pads are excluded from this 1 year warranty.  
A vacuum pad is a consumable part, so it is warranted for a year after it is delivered. Also, even within the warranty period, the wear of a product due to the use of the vacuum pad or failure due to the deterioration of rubber material are not covered by the limited warranty.

### Compliance Requirements

1. The use of SMC products with production equipment for the manufacture of weapons of mass destruction (WMD) or any other weapon is strictly prohibited.
2. The exports of SMC products or technology from one country to another are governed by the relevant security laws and regulations of the countries involved in the transaction. Prior to the shipment of a SMC product to another country, assure that all local rules governing that export are known and followed.

## Safety Instructions

Be sure to read “Handling Precautions for SMC Products” (M-E03-3) before using.



Revision History

Edition C	- A panel mount type has been added. - The number of pages has been increased from 12 to 16.	CU
-----------	---	----

SMC Corporation (Europe)

Austria	+43 (0)2262622800	www.smc.at	office@smc.at
Belgium	+32 (0)33551464	www.smc.be	info@smc.be
Bulgaria	+359 (0)2807670	www.smc.bg	office@smc.bg
Croatia	+385 (0)13707288	www.smc.hr	office@smc.hr
Czech Republic	+420 541424611	www.smc.cz	office@smc.cz
Denmark	+45 70252900	www.smc.dk.com	smc@smcdk.com
Estonia	+372 651 0370	www.smcee.ee	info@smcee.ee
Finland	+358 207513513	www.smc.fi	smc.fi@smc.fi
France	+33 (0)164761000	www.smc-france.fr	supportclient@smc-france.fr
Germany	+49 (0)61034020	www.smc.de	info@smc.de
Greece	+30 210 2717265	www.smchellas.gr	sales@smchellas.gr
Hungary	+36 23513000	www.smc.hu	office@smc.hu
Ireland	+353 (0)14039000	www.smcautomation.ie	sales@smcautomation.ie
Italy	+39 03990691	www.smcitalia.it	mailbox@smcitalia.it
Latvia	+371 67817700	www.smc.lv	info@smc.lv

Lithuania	+370 5 2308118	www.smclt.lt	info@smclt.lt
Netherlands	+31 (0)205318888	www.smc.nl	info@smc.nl
Norway	+47 67129020	www.smc-norge.no	post@smc-norge.no
Poland	+48 222119600	www.smc.pl	sales@smc.pl
Portugal	+351 214724500	www.smc.eu	apoioclientept@smc.smces.es
Romania	+40 213205111	www.smcromania.ro	smcromania@smcromania.ro
Russia	+7 (812)3036600	www.smc.eu	sales@smcru.com
Slovakia	+421 (0)413213212	www.smc.sk	office@smc.sk
Slovenia	+386 (0)73885412	www.smc.si	office@smc.si
Spain	+34 945184100	www.smc.eu	post@smc.smces.es
Sweden	+46 (0)86031240	www.smc.nu	smc@smc.nu
Switzerland	+41 (0)523963131	www.smc.ch	info@smc.ch
Turkey	+90 212 489 0 440	www.smcturkey.com.tr	info@smcturkey.com.tr
UK	+44 (0)845 121 5122	www.smc.uk	sales@smc.uk

South Africa	+27 10 900 1233	www.smcza.co.za	zasales@smcza.co.za
--------------	-----------------	-----------------	---------------------