

Before Use

Compact Wireless Base

EXW1-BENAC1



Thank you for purchasing an SMC EXW1-BENAC1 SMC Compact Wireless Base. Please read this manual carefully before operating the product and make sure you understand its capabilities and limitations. Please keep this manual handy for future reference.

To obtain the operation manual about this product and control unit, please refer to the SMC website (URL <https://www.smcworld.com>) or contact SMC directly.

Safety Instructions

These safety instructions are intended to prevent hazardous situations and/or equipment damage.

These instructions indicate the level of potential hazard with the labels of "Caution", "Warning" or "Danger". They are all important notes for safety and must be followed in addition to International standards (ISO/IEC) and other safety regulations.

- Danger:** DANGER indicates a hazard with a high level of risk which, if not avoided, will result in death or serious injury.
- Warning:** WARNING indicates a hazard with a medium level of risk which, if not avoided, could result in death or serious injury.
- Caution:** CAUTION indicates a hazard with a low level of risk which, if not avoided, could result in minor or moderate injury.

Operator

- ◆ This operation manual is intended for those who have knowledge of machinery using pneumatic equipment, and have sufficient knowledge of assembly, operation and maintenance of such equipment. Only those persons are allowed to perform assembly, operation and maintenance.
- ◆ Read and understand this operation manual carefully before assembling, operating or providing maintenance to the product.

Safety Instructions

Warning

- Do not disassemble, modify (including changing the printed circuit board) or repair. An injury or failure can result.
- Do not operate or set with wet hands. This may lead to an electric shock.
- Do not operate the product outside of the specifications. Do not use for flammable or harmful fluids. Fire, malfunction, or damage to the product can result. Verify the specifications before use.
- Do not operate in an atmosphere containing flammable or explosive gases. Fire or an explosion can result. This product is not designed to be explosion proof.
- If using the product in an interlocking circuit:
 - Provide a double interlocking system, for example a mechanical system.
 - Check the product regularly for proper operation.
 - Otherwise malfunction can result, causing an accident.
- The following instructions must be followed during maintenance:
 - Turn off the power supply.
 - Stop the air supply, exhaust the residual pressure and verify that the air is released before performing maintenance.
 - Otherwise an injury can result.

Caution

- When handling the unit or assembling/replacing units:
 - Do not touch the sharp metal parts of the connector or plug for connecting units.
 - Take care not to hit your hand when disassembling the unit. The connecting portions of the unit are firmly joined with seals.
 - When joining units, take care not to get fingers caught between units. An injury can result.
- After maintenance is complete, perform appropriate functional inspections. Stop operation if the equipment does not function properly. Safety cannot be assured in the case of unexpected malfunction.
- Provide grounding to assure noise resistance of the product. Individual grounding should be provided close to the product with a short cable.

NOTE

- The power is supplied from the circuit reinforced or double-insulated from MAINS.
- The direct current power supply used should be UL approved as follows. UL1310 Class 2 power supply unit or UL61010-1 LIM (Limited Energy Circuit).
- All external circuits should also be connected to a circuit that is reinforced or double-insulated from the MAINS and free from risk of electric shock and fire hazard.
- If the equipment is used in a manner not specified by the manufacturer, the protection provided by the equipment may be impaired.
- For UL/cUL certification, install in a distribution box or other container (EXW1-A1*).

[Limited warranty and Disclaimer]

1. The warranty period of the product is 1 year in service or 1.5 years after the product is delivered, whichever is first. Also, the product may have specified durability, running distance or replacement parts. Please consult your nearest sales branch.
2. For any failure or damage reported within the warranty period which is clearly our responsibility, a replacement product or necessary parts will be provided. This limited warranty applies only to our product independently, and not to any other damage incurred due to the failure of the product.
3. Prior to using SMC products, please read and understand the warranty terms and disclaimers noted in the specified catalog for the particular products.

<Important>

- The product must be used with a wireless adaptor attached.
- The wireless product is certified as wireless equipment in accordance with the Radio Act and the certification of construction type has been obtained. Customers do not need to apply for a license to use this equipment. Be sure to comply with the following precautions.
 - Do not disassemble or modify the product. Disassembly and modification are prohibited by law.
 - This product is compliant with the Radio Act in Japan, European countries and the US. For use in other countries, please consult SMC. For the latest information, refer to the catalog on the website below. URL <https://www.smcworld.com>
- This product communicates using radio waves, and the communication may be temporarily interrupted due to the ambient environments and operating methods. SMC will not be responsible for any secondary failure which may cause an accident or cause damage to other devices or equipment.
- When several units are installed close to each other, slight interference may occur due to the characteristics of the wireless product.
- Radio waves emitted by this product may adversely affect implantable medical devices such as implantable cardiac pacemakers and brillators. For precautions regarding the use of equipment or devices that may adversely affect performance, refer to the catalog or instruction manuals for the equipment or devices, or contact the manufacturers directly.
- The communication performance is affected by the ambient environment, so please perform communication testing before use.

Summary of Product elements

EXW1-BENAC1

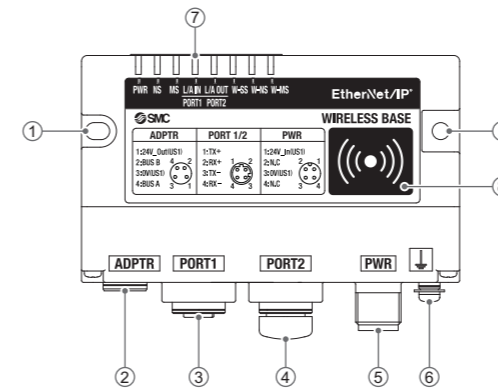

No.	Name	Application
1	Screw hole for mounting (2 x M4)	Mounting the compact wireless Base.
2	Connector for wireless adaptor (ADPTR)	Used to connect the cable for wireless adaptor.
3	Communication connector (PORT1)	Used to connect an Ethernet cable.
4	Communication connector (PORT2)	Used to connect an Ethernet cable.
5	Power supply connector	Supplies power to the compact wireless Base.
6	FE terminal	To be connected to Ground (for improved noise immunity).
7	LED	Indicates the status of the compact wireless Base or Remote.
8	NFC antenna approach area	This area is in close contact with the NFC reader/writer. "O" is the center of the NFC antenna.

*: Grounding should be as close as possible to the product and the grounding wire should be as short as possible.

Mounting and Installation

Installation

- To avoid damage to parts, apply the recommended tightening torque.
- Mount the product using two screws. 2 x M4 screws are required (Recommended torque = 0.8±10% N·m).

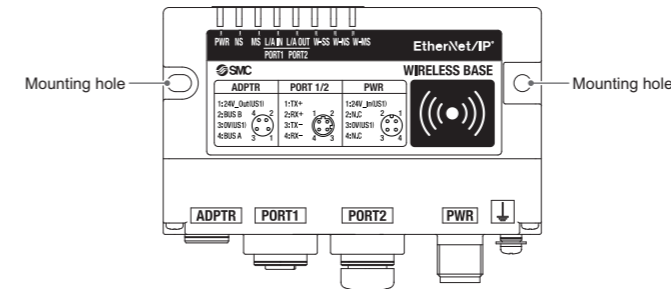

Connector

•Power supply connector

No.	Signal	M12, 4-pin, plug	
		A-coded	
1	24 V_In (US1)	2	1
2	NC	3	4
3	0 V (US1)		
4	NC		

•Communication connector for EtherNet/IP (PORT1/PORT2)

No.	Signal	M12, 4-pin, socket	
		D-coded	
1	TX+	1	2
2	RX+	3	4
3	TX-		
4	RX-		

•Connector for wireless adaptor

No.	Signal	M8, 4-pin, socket	
		A-coded	
1	24 V_Out (US1)	4	2
2	Internal BUS B	3	1
3	0 V (US1)		
4	Internal BUS A		

Caution

Use the special wireless adaptor cable to connect the compact wireless base to the wireless adaptor.

Wireless adaptor

- Integrated type (installation)
 - (1) Connection of the base and installation plate
 - Secure the installation plate to the base using the two self-tapping screws (M3 x 8) included with the wireless adaptor. The tightening torque should be 0.4 N·m±10%.

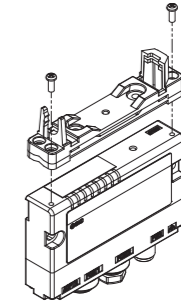

- (2) Installation of wireless adaptor
 - Clip the wireless adaptor onto the installation plate as shown below and secure the adaptor in place using the M10 nut already fitted to the wireless adaptor. The recommended tightening torque is 0.9 N·m±10%.

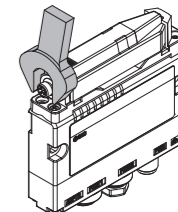
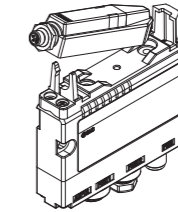

- (3) Connecting the cable for the wireless adaptor
 - Follow the procedure below to connect the cable for the wireless adaptor.
 - (1) Connect the U-side connector of the cable to the base.
 - (2) Connect the S-side connector of the cable to thetheadaptor.

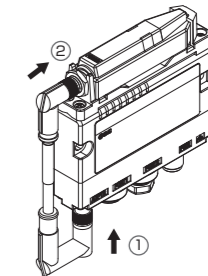

NOTE

Note the order of installation of the cable for the wireless adaptor.

•Flat surface mounting

- (1) Attachment of installation plate
 - Attach the installation plate to the target object by either of the following two methods.
 - Installation by M3 x 4 positions
 - The tightening torque should be 0.4 N·m±10%.

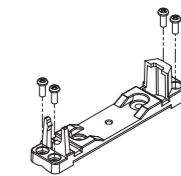

Installation by M4 x 2 positions

The tightening torque should be 0.6 N·m±10%.

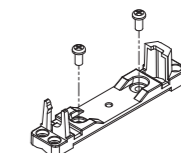

- (2) Installation of wireless adaptor
 - Clip the wireless adaptor onto the installation plate as shown below and secure the adaptor in place using the M10 nut already fitted to the wireless adaptor. The recommended tightening torque is 0.9 N·m±10%.

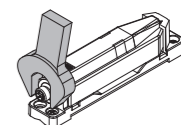
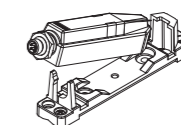

- (3) Connection of the cable for wireless adaptor
Connect the cable for wireless adaptor to the base and the wireless adaptor.

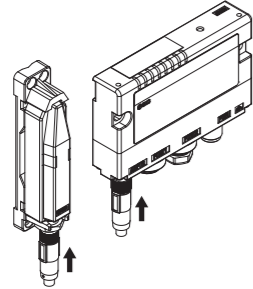

- Curved surface mounting
(1) Thread the top and bottom cable ties of the installation plate.

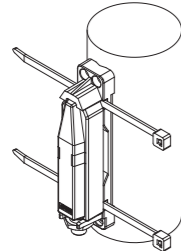

- (2) Tighten the wireless adaptor and the object to which it is to be fitted with cable ties.
Cut the base of the cable ties.

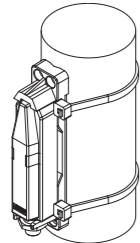

Setting and Adjustment

Flow chart for using the wireless system

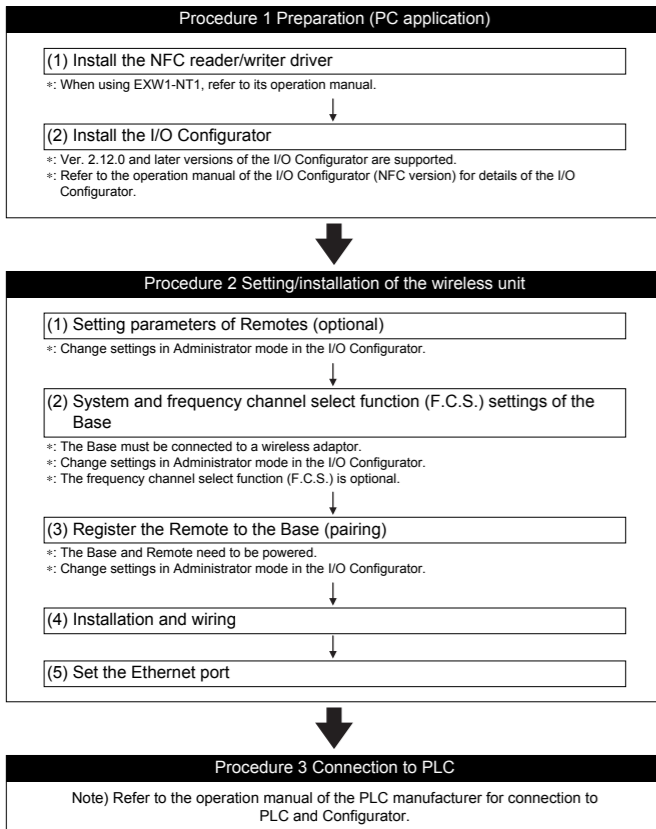

With the above settings, it is possible to control the upper level controller.
Refer to the operation manual for each manufacturer for how to set the controller and the PLC.

Refer to the I/O Configurator for NFC operation manual for details of the I/O Configurator.

LED Display

The LED indicators at the top left corner of the compact wireless Base indicate the power supply, communication and diagnostic status.

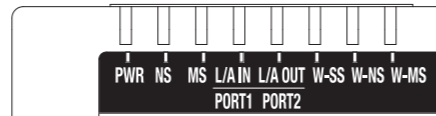

LED name	Function	LED status	Description
PWR	US1 (for control) power supply status indication	Green LED is ON	The US1 (for control) power supply is ON
		Orange LED is flashes	An internal communication error is detected
		Red LED is ON	Unrecoverable error is detected
NS	EtherNet/IP™ connection status	Green LED is ON	EtherNet/IP™ communication is established
		Green LED flashes	EtherNet/IP™ communication is not established
		Red LED flashes	EtherNet/IP™ communication time out
		Red LED is ON	Duplicated IP addresses are detected
		OFF	IP address not set
		Green LED is ON	The compact wireless Base is operating normally
MS	Base system status indication	Red LED is flashes	Recoverable error is detected (LED flashes when more than one diagnostic information item is detected) •US1 (for control) power supply voltage level is abnormal •Number of system inputs/outputs setting error •Abnormal number of registered Remotes •Internal communication error between wireless adaptors •Memory write/read error
		Red LED is ON	Unrecoverable error is detected
		OFF	The US1 (for control) power supply is OFF
		Green LED is ON	The compact wireless Base is operating normally
LINK/ACT1	Communication status of EtherNet/IP™ ports 1 and 2	Green LED is ON	Link, No Activity (100 Mbps)
		Green LED flashes	Link, Activity (100 Mbps)
LINK/ACT2	100 Mbps: Green 10 Mbps: Orange	Orange LED is ON	Link, No Activity (10 Mbps)
		Orange LED flashes	Link, Activity (10 Mbps)
W-SS	Radio wave receiving intensity	Green LED is ON	The level of received radio wave strength of all the connected remotes is 3
		Green LED is flashes (1 Hz)	The level of received radio wave strength of some connected remotes is 2
		Green LED is flashes (2 Hz)	The level of received radio wave strength of some connected remotes is 1
		Red LED is flashes	All the Remotes that support protocol V.1.0 are not connected
		Orange LED is flashes	All the Remotes that support protocol V.2.0 are not connected
		OFF	Remote not registered
W-NS	Wireless communication connection status indication	Green LED is ON	All the Remote connections are normal
		Green LED is flashes	Some Remotes are not connected
		Red LED is flashes	No Remotes are connected
		Red LED is ON	No Remotes are connected (Unrecoverable error in wireless communication)
		Red/Green	Wireless communication connection is being configured (Pairing mode)
		Orange LED is ON	Forced output mode
W-MS	Remote system status indication	Green LED is ON	Wireless Remote is normal Protocol V.1.0 (Pairing mode)
		Orange LED is ON	Protocol V.2.0 (Pairing mode)
		Red LED is flashes	Recoverable error is detected (LED flashes when more than one diagnostic information item is detected) •US1 (for control/input) power supply voltage level is abnormal •US2 (for output) power supply voltage level is abnormal •Excessive I/O setting inputs/outputs •Analog I/O upper setting limit exceeded •Analog input range upper and lower limits exceeded •Error in communication between units •EX600 I/O unit detects diagnostic information •Valve diagnostic information detected
		Red LED is ON	Unrecoverable error is detected
		OFF	Remote not registered
		Green LED is ON	Wireless Remote is normal Protocol V.1.0 (Pairing mode)

Wireless adaptor
EXW1-A11#s LED indications

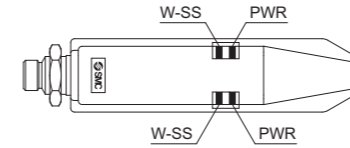

LED name	Function	LED status	Description
PWR	Power supply and status indication	Green LED is ON	Power supply voltage is in ON state
		Orange LED is flashes	An internal communication error is detected
		Red LED is ON	Unrecoverable error is detected
		OFF	Power supply voltage is in OFF state
W-SS	Radio wave receiving intensity	Green LED is ON	The level of received radio wave strength of all the connected remotes is 3
		Green LED is flashes (1 Hz)	The level of received radio wave strength of some connected remotes is 2
		Green LED is flashes (2 Hz)	The level of received radio wave strength of some connected remotes is 1
		Red LED is flashes	Protocol V.1.0 all remote is not established
		Orange LED is flashes	Protocol V.2.0 all remote is not established
		OFF	Remote not registered

Environment

Item	Details
Operating temperature	-10 to 50 °C (No condensation or freezing)
Ambient humidity	35 to 85%RH
Altitude	Up to 3000 m
US1 power supply voltage range	24V DC +/-10%
Current Consumption	150 mA
Pollution Degree	3
Installation place	Indoor

Maintenance

- Maintenance should be performed according to the Safety Instructions.
- Perform regular maintenance and inspections.
There is a risk of unexpected malfunction.
- Do not use solvents such as benzene, thinner etc. to clean each unit.
They could damage the surface of the body and erase the markings on the body.
Use a soft cloth to remove stains.
For heavy stains, use a cloth soaked with diluted neutral detergent and fully squeezed, then wipe up the stains again with a dry cloth.

Refer to the SMC website (URL <https://www.smcworld.com>) to obtain more detailed information about maintenance.

Troubleshooting

Refer to the LED Display. Refer to the SMC website (URL <https://www.smcworld.com>) to obtain more detailed information about troubleshooting.

Specification

Remote can be used regardless of the communication specification of the Base.

Refer to the product catalog or SMC website (URL <https://www.smcworld.com>) to obtain more detailed information about product specifications.

Commissioning

- Parameter Setting
- Hardware Configuration
- I/O Map

Refer to the SMC website (URL <https://www.smcworld.com>) to obtain more detailed information about these setting above.

Diagnostic

Refer to the SMC website (URL <https://www.smcworld.com>) to obtain more detailed information about diagnostic.

Outline with Dimensions

Refer to the product catalog or SMC website (URL <https://www.smcworld.com>) to obtain more detailed information about outline dimensions.

Contacts

AUSTRIA	(43) 2262 62 280 Girakstrasse 8, AT-2100 Korneuburg, Austria
BELGIUM	(32) 03 355 1464 Temesselei 232, 2160 Wommelgem, Belgium
BULGARIA	(359) 2 9744492 Business Park Sofia, Building 8c, 6th floor, BG-1766 Sofia, Bulgaria
CROATIA	(385) 1 370 72 88 Zagrebačka Avenija 104, HR-10000 Zagreb, Croatia
CZECH REP.	(420) 5 414 24611 Hudcova 78a, CZ-61200 Brno, Czech Republic
DENMARK	(45) 70252900 Egeskovvej 1, DK-8700 Horsens, Denmark
ESTONIA	(372) 651 0370 Laki 12, EE-10621 Tallinn, Estonia
FINLAND	(358) 207 513513 PB72, 02231, Espoo, Finland
FRANCE	(33) 1 6476 1000 1, Boulevard de Strasbourg, Parc Gustave Eiffel Bussy Saint Georges F-77607 Marne La Vallee Cedex 3, France
GERMANY	(49) 6103 402 0 Boschring 13-15, 63329 Egelsbach, Germany
GREECE	(30) 210 271 7265 Anagenniseos 7-9-P.C. 14342 N. Philadelphia, Athens, Greece
HUNGARY	(36) 23 513 000 Torbágy u. 15-19, 2045 Törökbálint, Hungary
IRELAND	(353) 1 403 9000 2002 Citywest Road, Citywest Business Campus, Citywest, Dublin 24, Ireland
ITALY	(39) 02 92711 Via Garibaldi 62, 20061 Carugate, (Milano), Italy
LATVIA	(371) 781 77 00 Dzelzavas str. 120g, Riga, LV-1021, Latvia
LITHUANIA	(370) 5 264 81 26 Oslo g. 1, LT-04123 Vilnius, Lithuania
NETHERLANDS	(31) 020 5318888 De Ruyterkade 120, NL-1011 AB Amsterdam, the Netherlands
NORWAY	(47) 67 12 90 20 Vollsveien 13 C, Granfos Næringspark N-1366 Lysaker, Norway
POLAND	(48) 22 211 96 00 ul. Poloneza 89, 02-826 Warszawa, Poland
PORTUGAL	(351) 21 472 45 00 Alameda dos Moinhos, 9G, 2720-381 Alfragide Portugal
ROMANIA	(40) 213205111 Str Frunzei 29, Sector 2, Bucharest, Romania
SLOVAKIA	(421) 41 321321 1 Fantranská 1223, 01301 Teplička nad Váhom, Slovakia
SLOVENIA	(386) 7388 5412 Mirnska cesta 7, SLO-8210 Trebnje, Slovenia
SPAIN	(34) 945 184 100 Zuazobidea 14, 01015 Vitoria, Spain
SWEDEN	(46) 8 603 12 00 Ekhagsvägen 29-31, SE-141 71 Segeltorp, Sweden
SWITZERLAND	(41) 052 396 31 31 Dorfstrasse 7, CH-8484, Weisslingen, Switzerland
UNITED KINGDOM	(44) 0845 121 5122 Vincent Avenue, Crownhill, Milton Keynes, Buckinghamshire MK8 0AN, United Kingdom

SMC Corporation URL <https://www.smcworld.com>

Akihara UDX 15F, 4-14-1, Sotokanda, Chiyoda-ku, Tokyo 101-0021, JAPAN
Phone: +81 3-5207-8249 Fax: +81 3-5298-5362

Note: Specifications are subject to change without prior notice and any obligation on the part of the manufacturer.
EtherNet/IP™ is a registered trademark of ODVA, Inc.
© SMC Corporation All Rights Reserved